

# Proximity switches

Proximity switches	Page
Proximity switches	70
Accessories proximity switches	74

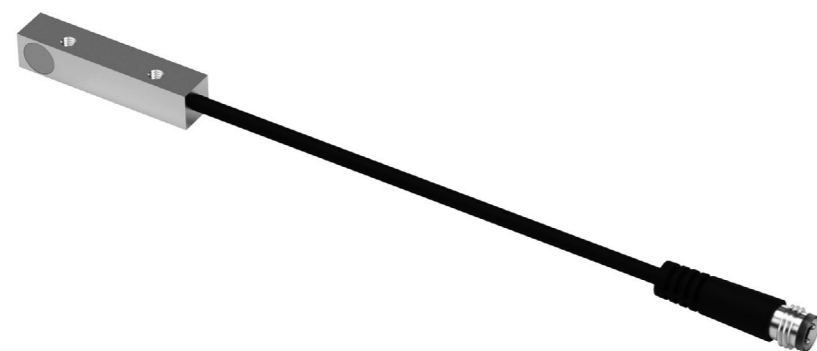

	INI d3x12-Sn0.8-PNP-NO	INI d3x22-Sn0.8-PNP-NO-M8x1	INI d4/6.5x45-Sn1.0-PNP-NO-M8x1	INI M4x12-Sn0.8-PNP-NO	INI d4x25-Sn1.0-PNP-NC-M8x1	INI d4x25-Sn1.0-PNP-NO-M8x1	INI d5x36-Sn2.0-PNP-NC-M8x1	INI 6.3x4.7x26.3-Em-PNP-NO-M8x1	INI d6.5x35-Sn1.5-PNP-NO-M8x1	INI d6.5x44-Sn1.5-PNP-NO-M8x1	INI 8x4.7x16-Sn2.0-PNP-NC-M8x1	INI 8x8x38.5-Sn1.5-PNP-NO-M8x1	INI d8x36-Sn2.0-PNP-NC-M8x1	INI c10x9-Em-PNP-NO-M8x1	INI c10x19.5-Em-PNP-NO-M8x1	INI c10x28.5-Em-PNP-NO-M8x1	INI 10.5x5.8x30-Em-PNP-NO-M8x1
CS 6																	
CS 8																	
CS 12																	
CS 16																	
ZA-CS 16																	
CS 20																	
ZA-CS 20																	
CS 25																	
ZA-CS 25																	
LM 12																	
PS 16																	
PS 25																	
PS 32																	
LM 16																	
LM 20																	
LM 25																	
ZA 20/25																	
LM 32																	
ZA 32																	
ZA-PS																	
HM 10																	
HM 16																	
HM 25																	
PMP																	
ZA-PMP																	
PMP-c																	
OZ-50																	
OZ-60																	
PEZ-52																	
PEZ-65																	
PEZ-80																	
PEZ-100																	
PDZ-128																	
PDZ-160																	
PDZ-200																	
CR 12																	
CR 16																	
CR 20																	
CR 25																	
CR 32																	
RM 12																	
RMZ 12																	
RM 16																	
RM 25																	
RM 32																	
RM 63																	
PG 12																	
PG 16																	
PG 20																	
UG 20																	
UG 25																	
GMO 12																	
GMO 20																	
GMO 32																	
DG 16																	
DG 20																	
EU-12																	
EU-20																	
EG-12																	
EG-20																	
RE-50																	
RE-75																	

50448226	50001023	11009034	50448225	50093507	11016714	50285525	11010759	50003811	11005439	50230625	50428013	50144770	50313986	50313987	50033432	11012933
----------	----------	----------	----------	----------	----------	----------	----------	----------	----------	----------	----------	----------	----------	----------	----------	----------

M8x1: Connection thread

PNP: PNP  
NO: Normally open  
NC: Normally close

d: Diameter  
Em: Electromagnetic  
Sn: Switching distance

INI: Proximity switch  
c: C-slot

Standard  
Alternative

Proximity switches

INI d3x12-Sn0.8-PNP-NO	
Order number	50448226
Net weight	0.01 kg

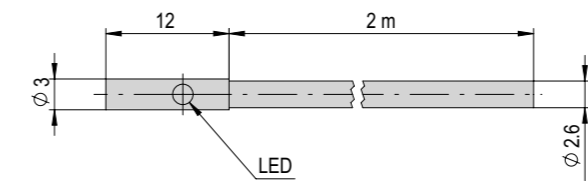

INI d3x22-Sn0.8-PNP-NO-M8x1	
Order number	50001023
Net weight	0.005 kg
Operating voltage	10 - 30 VDC
Switching distance	0.8 mm

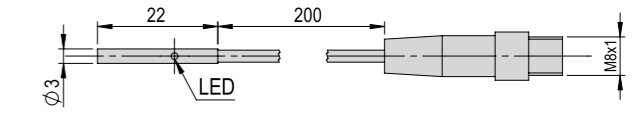

INI d4/6.5x45-Sn1.0-PNP-NO-M8x1	
Order number	11009034
Net weight	0.008 kg
Operating voltage	10 - 30 VDC
Switching distance	0.8 mm

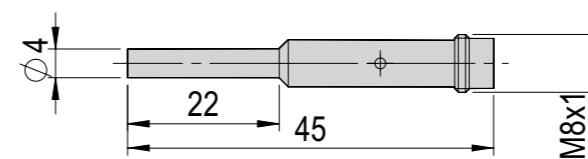

INI d4x25-Sn1.0-PNP-NC-M8x1	
Order number	50093507
Net weight	0.004 kg
Operating voltage	10 - 30 VDC
Switching distance	1.0 mm

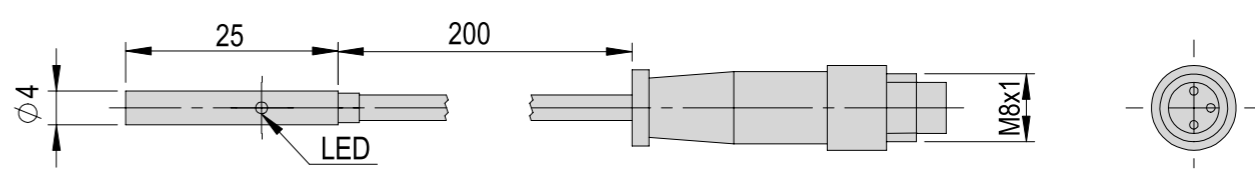

INI d4x25-Sn1.0-PNP-NO-M8x1	
Order number	11016714
Net weight	0.002 kg
Operating voltage	10 - 30 VDC
Switching distance	1.0 mm

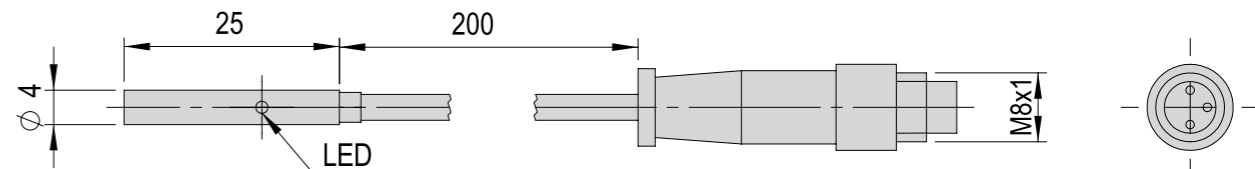

INI M4x12-Sn0.8-PNP-NO

<b>Order number</b>	<b>50448225</b>
Net weight	0.01 kg

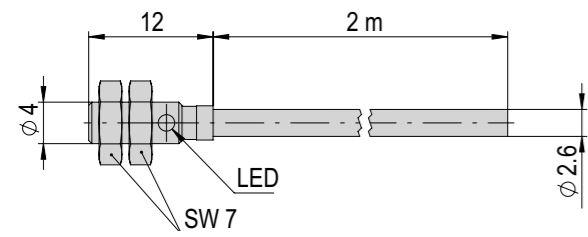

INI d5x36-Sn2.0-PNP-NC-M8x1

<b>Order number</b>	<b>50285525</b>
Net weight	0.007 kg
Operating voltage	10 - 30 VDC
Switching distance	1.5 mm

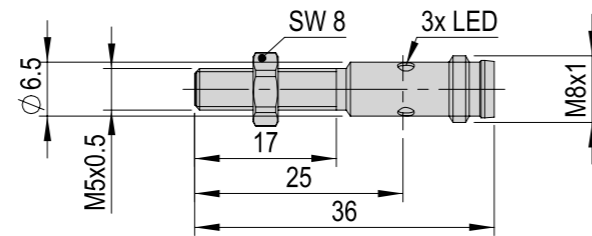

INI 6.3x4.7x26.3-Em-PNP-NO-M8x1

<b>Order number</b>	<b>11010759</b>
Net weight	0.007 kg
Operating voltage	10 - 30 VDC

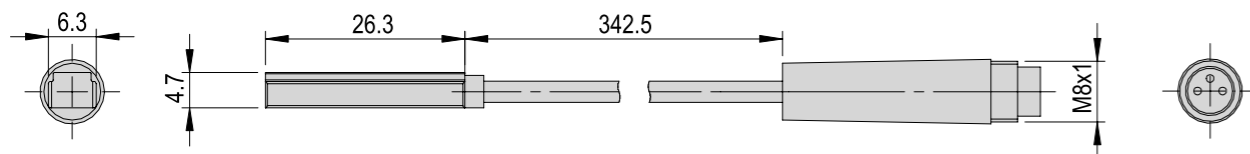

INI d6.5x35-Sn1.5-PNP-NO-M8x1

<b>Order number</b>	<b>50003811</b>
Net weight	0.009 kg
Operating voltage	10 - 30 VDC
Switching distance	1.5 mm

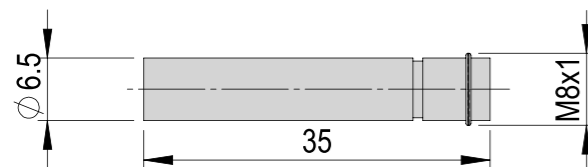

INI d6.5x44-Sn1.5-PNP-NO-M8x1

<b>Order number</b>	<b>11005439</b>
Net weight	0.005 kg
Operating voltage	10 - 30 VDC
Switching distance	1.5 mm

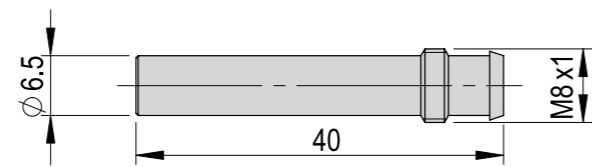

INI 8x4.7x16-Sn2.0-PNP-NC-M8x1

<b>Order number</b>	<b>50230625</b>
Net weight	0.004 kg
Operating voltage	10 - 30 VDC
Switching distance	1.5 mm

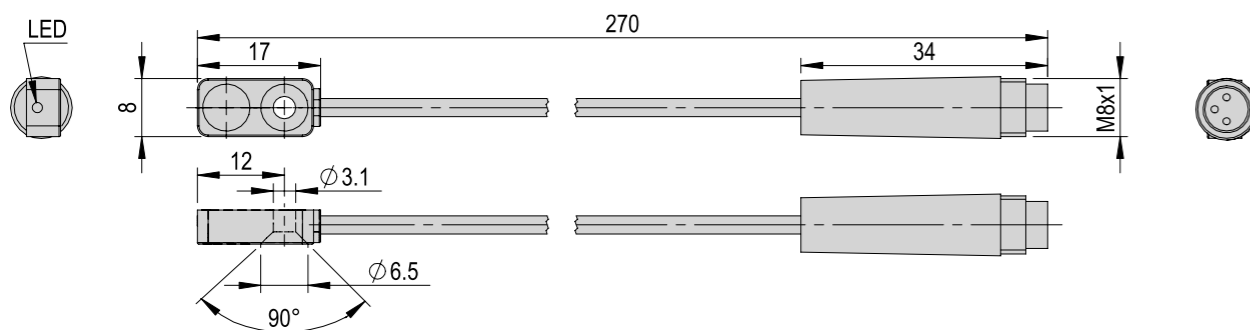

INI 8x8x38.5-Sn1.5-PNP-NO-M8x1

<b>Order number</b>	<b>50428013</b>
Net weight	0.043
Operating voltage	10 - 30 VDC
Switching distance	1.5 mm

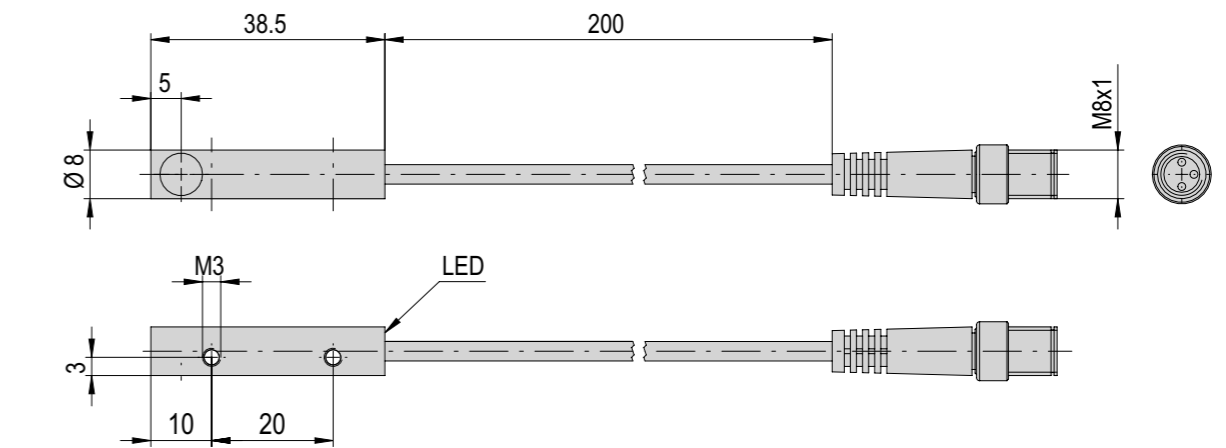

INI d8x36-Sn2.0-PNP-NC-M8x1

<b>Order number</b>	<b>50144770</b>
Net weight	0.014 kg
Operating voltage	10 - 30 VDC
Switching distance	1.5 mm

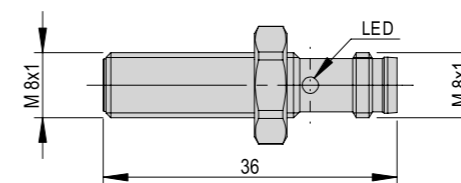

INI c10x9-Em-PNP-NO-M8x1

<b>Order number</b>	<b>50313986</b>
Net weight	0.02 kg
Operating voltage	10 - 30 VDC

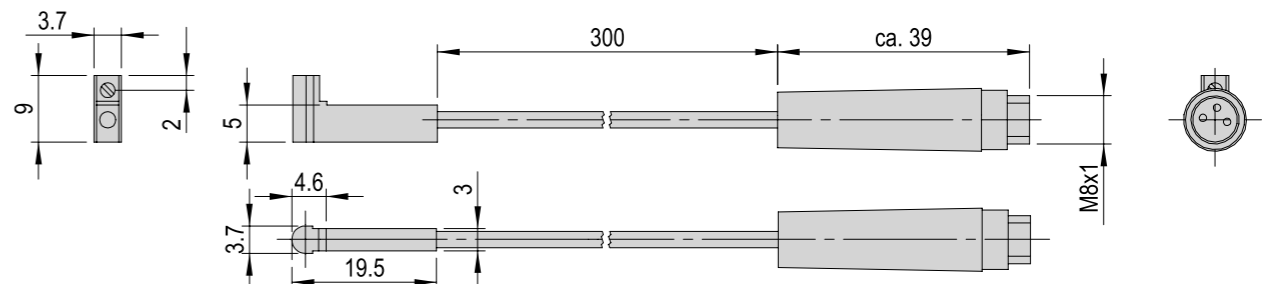

INI c10x19.5-Em-PNP-NO-M8x1

<b>Order number</b>	<b>50313987</b>
Net weight	0.021 kg
Operating voltage	10 - 30 VDC

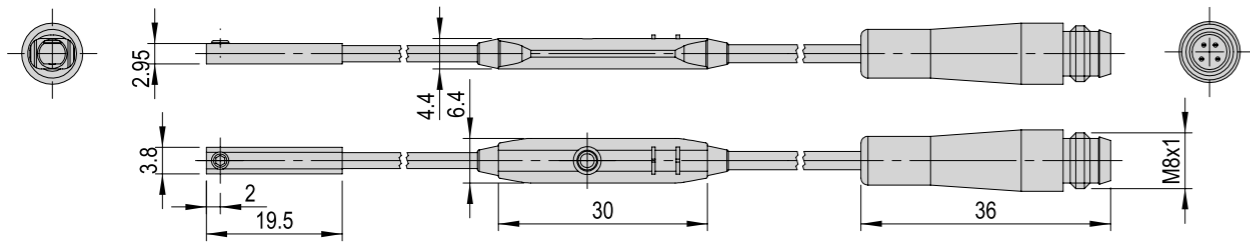

INI c10x28.5-Em-PNP-NO-M8x1

<b>Order number</b>	<b>50033432</b>
Net weight	0.02 kg
Operating voltage	10 - 30 VDC

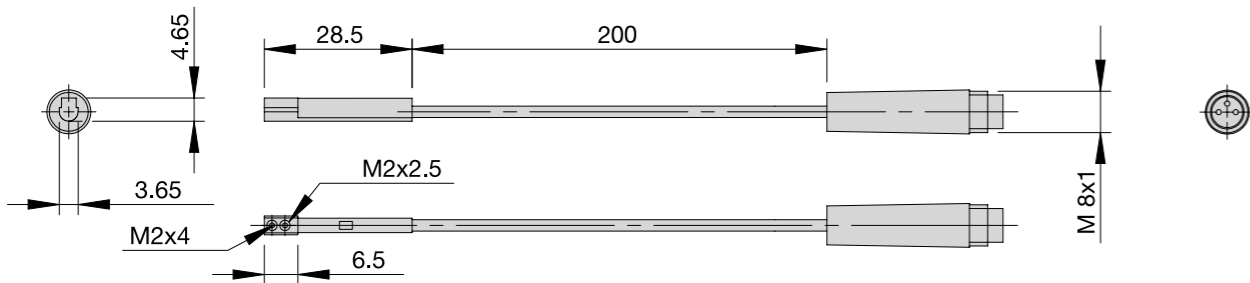

INI 10.5x5.8x30-Em-PNP-NO-M8x1

<b>Order number</b>	<b>11012933</b>
Net weight	0.013 kg
Operating voltage	10 - 30 VDC

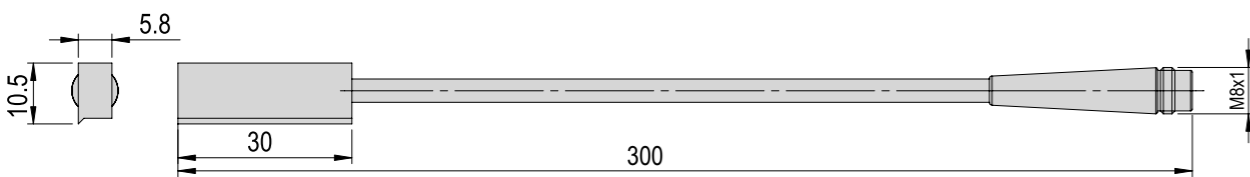

## Accessories proximity switches

Clamping nut M6x1

<b>Order number</b>	<b>50042748</b>
Net weight	0.001 kg
Ø	4 mm
Thread	M6 x 1 mm

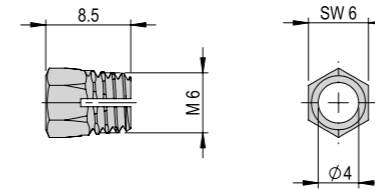

Clamping nut M8x0.75

<b>Order number</b>	<b>11005436</b>
Net weight	0.001 kg
Ø	6.5 mm
Thread	M8 x 0.75 mm

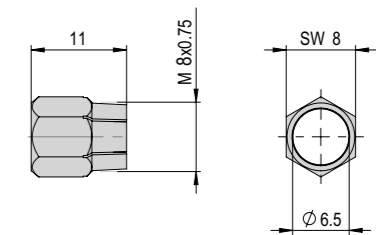

Proximity switch holder IH9.5/8x8

<b>Order number</b>	<b>11004997</b>
Net weight	0.021 kg
Ø	8x8 mm
Material	Die-cast zinc

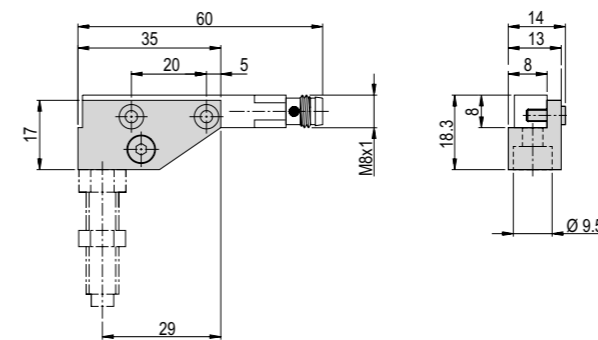

Proximity switch holder IH10/6.5

<b>Order number</b>	<b>11004995</b>
Net weight	0.015 kg
Ø	6.5 mm
Material	Brass nickel-plated

