

# Interruttori di manovra sezionatori con portafusibili

## Switch disconnectors fuses

# VCF 32 ÷ 800 A

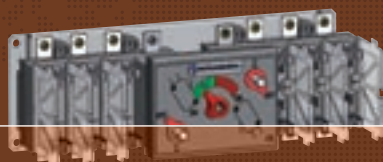
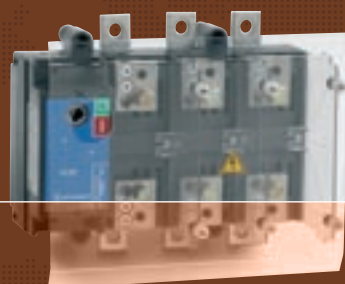
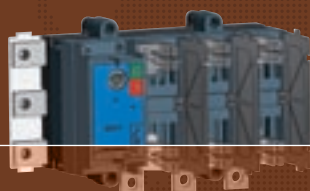
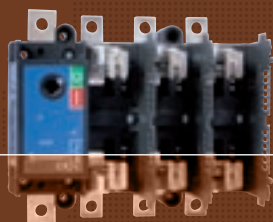

generalità generalities	IV - 02
codici ordinazione order references	IV - 03
dati tecnici technical data	IV - 04
dimensionali dimensions	IV - 06
VCF con attacchi laterali \ with side connections codici ordinazione order references	IV - 09
dimensionali dimensions	IV - 10
VISUALCOMPACT Fu generalità   codici ordinazione generalities   order references	IV - 12
dimensionali dimensions	IV - 13
VISUALCOMPACT FBA generalità   codici ordinazione   accessori generalities   order references   accessories	IV - 15
dimensionali dimensions	IV - 16
VCF MS generalità   codici ordinazione generalities   order references	IV - 17
dimensionali dimensions	IV - 18
EOF codici ordinazione order references	IV - 20
dimensionali dimensions	IV - 21
accessori accessories	IV - 24
dimensionali maniglie handle dimensions	IV - 30

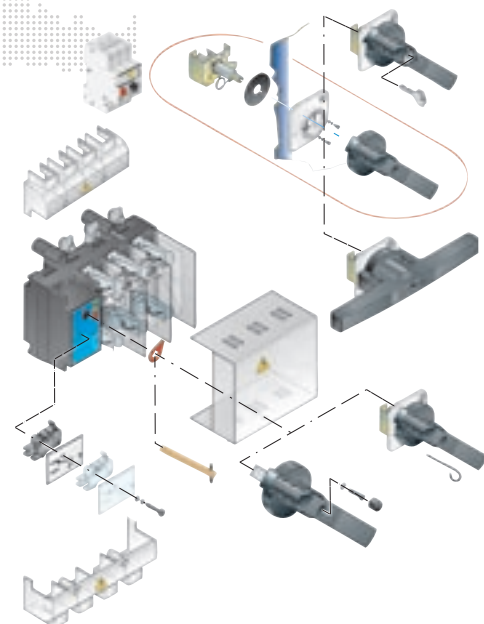

**GENERALITA'**

**VISUALCOMPACT F** è una serie di interruttori di manovra sezionatori con portafusibili che consentono l'apertura e la chiusura di circuiti elettrici in bassa tensione. Sono comunemente impiegati per le seguenti funzioni:

- ▶ interruttore generale
- ▶ interruttore per motori
- ▶ sezionatore
- ▶ interruttore di sicurezza

Sono disponibili 5 grandezze per 13 diversi valori di corrente nominale.

**CARATTERISTICHE GENERALI**

- ▶ tensione di isolamento nominale 1000V c.a. e 1500V c.c.
- ▶ disponibili 3 - 4 poli
- ▶ alto potere di interruzione (AC-22, AC-23, IEC 60947-3)
- ▶ elevata durata meccanica ed elettrica
- ▶ quattro interruzioni per ogni polo
- ▶ contatti autopulenti
- ▶ basi portafusibili isolate su entrambi i lati con interruttore aperto
- ▶ possibilità di montaggio fusibili tipo DIN, BS e NFC
- ▶ la posizione della maniglia costituisce un'indicazione positiva e affidabile della posizione dei contatti
- ▶ visibilità diretta mediante finestrelle, dei contatti fissi e mobili
- ▶ manovra a scatto rapido indipendente
- ▶ polo neutro con contatti ad apertura posticipata e chiusura anticipata rispetto ai contatti di fase
- ▶ disponibile versione con polo neutro passante
- ▶ protezione adeguata per prevenire contatti accidentali
- ▶ involucro in materiali autoestinguenti (classe V0-UL94) a bassa igroscopicità, ad alta resistenza meccanica e alle correnti superficiali
- ▶ adatto per utilizzo in climi tropicali
- ▶ ampia gamma di accessori
- ▶ comando di tipo rotativo frontale a mezzo di: maniglia esterna a doppio isolamento con blocco porta in posizione I, grado di protezione IP65, possibilità di 3 blocchi con lucchetto in posizione 0
- ▶ maniglia diretta (a richiesta lucchettabile in posizione 0)

**CONDIZIONI NORMALI DI SERVIZIO, MONTAGGIO E TRASPORTO**

- ▶ temperatura ambiente di immagazzinamento e trasporto - 25°C + 55°C
- ▶ temperatura ambiente di funzionamento - 20°C + 40°C
- ▶ in caso di temperatura ambiente ( $t_a$ ) superiore, applicare la seguente formula di declassamento:

$$I_{the} = k I_{th} \text{ dove } K = 1 - \frac{t_a - 40}{100}$$

- ▶ umidità relativa max 95 %
- ▶ frequenza nominale 50-60Hz
- ▶ altitudine max 2000 m s.l.m.
- ▶ grado di inquinamento 3 secondo IEC 60947-1
- ▶ possono essere montati in qualsiasi posizione
- ▶ montaggio in custodia: in caso di utilizzo a piena corrente e in mancanza di adeguata ventilazione assicurare un volume pari a circa 5 volte quello dell'apparecchio
- ▶ tipo di servizio (secondo IEC 60947-1): 8 ore; ininterrotto; intermittente 60% classe 30; temporaneo; periodico

Per condizioni di impiego diverse consultare il costruttore.

**CONFORMITA' ALLE NORME**

IEC 60947-3 | IEC 60947-1 | CEI EN 60947-3 | CEI EN 60947-1 | VDE 0660 Teil 107

**CERTIFICATI E OMOLOGAZIONI**

KEMA | RINA | ENEL codice 13.32.23 | A2A | CESI | IENGF

**GENERALITIES**

**VISUALCOMPACT F** is a range of switch disconnectors fuse suitable for making and breaking on load and disconnecting low voltage electrical circuits. They are commonly used for the following purposes:

- ▶ main switch
- ▶ switch for motors
- ▶ disconnector
- ▶ safety switch

They are available in 5 sizes and 13 current ratings.

**GENERAL CHARACTERISTICS**

- ▶ rated insulation voltage 1000V AC and 1500V DC
- ▶ 3 - 4 poles available
- ▶ high breaking capacity (AC-22, AC-23, IEC 60947-3)
- ▶ high electrical and mechanical endurance
- ▶ four break contacts
- ▶ self cleaning contacts
- ▶ both fuse terminals are not alive when the switch is in 0 position
- ▶ suitable for DIN, BS and NFC fuses
- ▶ contact position positively indicated by the handle
- ▶ visibility of fixed and moving contacts by means of windows
- ▶ independent manual operation
- ▶ neutral contact makes earlier and opens later than the phase contacts
- ▶ solid neutral version available
- ▶ suitable protection to prevent accidental touching of live parts
- ▶ casing in self-extinguishing (V0-UL94), low hygroscopic and high mechanical resistance isolating material
- ▶ resistant to damp heat
- ▶ wide range of accessories
- ▶ rotary front operation by means of: external double insulated handle with door-interlock in ON position, IP65 degree of protection. Padlockable with three padlocks in OFF position
- ▶ direct handle (padlockable in OFF position on request)

**NORMAL SERVICE, MOUNTING AND TRANSPORT CONDITIONS**

- ▶ storage and transport ambient temperature - 25°C + 55°C
- ▶ working ambient temperature - 20°C + 40°C
- ▶ in case of higher ambient temperature ( $t_a$ ) consider the following derating formula:

$$I_{the} = k I_{th} \text{ where } K = 1 - \frac{t_a - 40}{100}$$

- ▶ relative humidity max 95%
- ▶ rated frequency 50-60Hz
- ▶ altitude max 2000 m a.s.l.
- ▶ pollution degree 3 according IEC 60947-1
- ▶ can be mounted in any position
- ▶ mounting in enclosure: in case of utilisation at full load and without adequate ventilation, ensure a volume of about 5 times the volume of the switch duty (IEC 60947-1): 8 hours; uninterrupted; intermittent 60% class 30; temporary; periodic

For other operating conditions contact the manufacturer.

**CONFORMITY TO STANDARDS**

IEC 60947-3 | IEC 60947-1 | CEI EN 60947-3 | CEI EN 60947-1 | VDE 0660 Teil 107

**CERTIFICATES AND APPROVALS**

KEMA | RINA | ENEL code 13.32.23 | A2A | CESI | IENGF



VCF1F



VCF2F



VCF3F

Tipo Type	Corrente nomiale Rated current	Tipo di fusibile Fuse type			Poli Poles	Senza maniglia \ Without handle			Maniglia blocco porta \ Door interlock handle			
		NFC	DIN	BS		NFC	DIN	BS	NFC	DIN	BS	
		Codice \ Code										
VC1F	32A	14x51	NH C00	A2	3	11020SM	11040SM	11060SM	11020	11040	11060	
					4	11030SM	11050SM	11070SM	11030	11050	11070	
	45A	14x51	NH C00	A2-A3	3	11021SM	11041SM	11061SM	11021	11041	11061	
					4	11031SM	11051SM	11071SM	11031	11051	11071	
	VC1F	63A	22x58	NH C00	A2-A3	3	11022SM	11042SM	11062SM	11022	11042	11062
						4	11032SM	11052SM	11072SM	11032	11052	11072
80A		22x58	NH C00	▷ OSD	3	11023SM	11043SM	11063SM	11023	11043	11063	
					4	11033SM	11053SM	11073SM	11033	11053	11073	
100A	22x58	NH C00	▷ OSD	3	11024SM	11044SM	11064SM	11024	11044	11064		
				4	11034SM	11054SM	11074SM	11034	11054	11074		
VC2F	100 A	22x58	NH 00	A4	3	12021SM	12041SM	12060SM	12021	12041	12060	
					4	12031SM	12051SM	12070SM	12031	12051	12070	
	125 A	22x58	NH 00	▷ DEO	3	12022SM	12042SM	12061SM	12022	12042	12061	
					4	12032SM	12052SM	12071SM	12032	12052	12071	
	-	-	NH 0	-	3	-	12044SM	-	-	12044	-	
					4	-	12054SM	-	-	12054	-	
	160 A	-	-	NH 00	▷ DEO	3	-	12043SM	12062SM	-	12043	12062
						4	-	12053SM	12072SM	-	12053	12072
		-	-	NH 0	-	3	-	12045SM	-	-	12045	-
						4	-	12055SM	-	-	12055	-
	VC3F	200 A	-	NH 1	B1-B2	3	-	13041SM	13061SM	-	13041	13061
						4	-	13051SM	13071SM	-	13051	13071
250 A		-	NH 1	B1-B3	3	-	13042SM	13062SM	-	13042	13062	
					4	-	13052SM	13072SM	-	13052	13072	
VC4F	315 A	-	NH 2	B1-B3	3	-	14022SM	14042SM	-	14022	14042	
					4	-	14032SM	14052SM	-	14032	14052	
400 A	-	NH 2	B1-B4	3	-	14023SM	14043SM	-	14023	14043		
				4	-	14033SM	14053SM	-	14033	14053		
VC5	630 A	-	NH 3	C2	3	-	15020SM	15040SM	-	15020	15040	
					4	-	15030SM	15050SM	-	15030	15050	
	800 A	-	NH 3	C3	3	-	15022SM	15041SM	-	15022	15041	
					4	-	15032SM	15051SM	-	15032	15051	

▷ Fuori standard BS | Albero di comando standard lunghezza 200 mm incluso in ogni confezione.

▷ Not BS standard | Standard shaft length 200 mm included in the package.

▷ Sono disponibili interruttori di manovra-sezionatori con portafusibili a 6-8 poli.

Per informazioni contattare TECHNOELECTRIC.

▷ Available switch disconnectors fuse 6-8 poles version. For information contact TECHNOELECTRIC.

Tipo \ Type			VCF					
Corrente nominale \ Rated current	In	A	32	45	63	80	100	
Tensione nominale d'isolamento \ Rated insulation voltage	Ui	V	1.000	1.000	1.000	1.000	1.000	
Tensione nominale impulso \ Impulse withstand voltage	U imp	kV	8	8	8	8	8	
Corrente nominale termica \ Rated thermal current	Ith	A	32	45	63	80	100	
<b>Corrente nominale d'impiego le \ Rated operational current</b>								
AC-21A	400V	A	32	45	63	80	100	
	500V	A	32	45	63	80	100	
	690V	A	32	45	63	80	100	
AC-22A	400V	A	32	45	63	80	80	
	500V	A	32	45	63	80	80	
	690V	A	32	45	63	80	80	
AC-23A	400V	A	32	45	63	80	80	
	500V	A	25	32	45	63	63	
	690V	A	20	25	32	45	45	
DC-21A(1)	48V	A	32	50	63	80	100	
	110V	A	32	50	63	80	100	
	220V	A	32	50	63	80	100	
	400V	A	-	-	-	-	-	
	500V	A	-	-	-	-	-	
	600V	A	-	-	-	-	-	
DC-22A(1)	48V	A	32	50	63	80	80	
	110V	A	32	50	63	80	80	
	220V	A	32	50	63	80	80	
	400V	A	-	-	-	-	-	
	500V	A	-	-	-	-	-	
	600V	A	-	-	-	-	-	
DC-23A(1)	48V	A	32	50	63	80	80	
	110V	A	32	50	50	63	80	
	220V	A	32	50	50	50	63	
	400V	A	-	-	-	-	-	
Potenza nominale d'impiego \ Rated operational power	AC-23-A	400V	kW	17	23	33	42	42
<b>Corrente di corto circuito condizionata da fusibile \ Rated fuse short circuit current</b>								
Tipo fusibile \ Back up fuse	A		32	45	63	80	80	
Valore efficace \ R.M.S. value	kA		50	50	50	50	50	
Valore di picco \ Peak value	kA		6	9	10	12	12	
Potere di chiusura nominale 420V c.a. cos $\theta$ 0,35 (0,45*) Rated making capacity at 420V AC cos $\theta$ 0,35 (0,45*)	A		320*	450*	630*	800*	800*	
Potere di interruzione nominale 420V cos $\theta$ 0,35 (0,45) Rated breaking capacity at 420V cos $\theta$ 0,35 (0,45)	A		256*	360*	504*	640*	640*	
Potere di chiusura e interruzione nominale c.c. (230V L/R=15) Road making and breaking capacity DC (230V L/R=15)	A		80	120	140	180	180	
Potenza condensatori \ Rated capacitor power at 400V	kVAR		15	20	30	40	45	
Durata meccanica \ Mechanical endurance	n		10.000	10.000	10.000	10.000	10.000	
Durata elettrica \ Electrical endurance	n		1.500	1.500	1.500	1.500	1.500	
Potenza dissipata per polo \ Power losses for pole	W		1,2	1,2	1,2	1,2	1,2	
Dimensione cavo \ Cable section	mmq		10	10	16	25	35	
Dimensione barre \ Bars dimension	mm		12x2	12x2	12x3	12x3	14x3	
Sforzi di manovra \ Operation torque	Nm		8	8	8	8	8	
Peso netto \ Net weight	3P	kg	1	1	1	1	1	
	4P	kg	1,1	1,1	1,1	1,1	1,1	

▶ Due poli in serie \ Two poles in series    ▶▶ Escluso fusibile / Fuse not considered

VC2F			VC3F		VC4F		VC5F	
100	125	160	200	250	315	400	630	800
1.000	1.000	1.000	1.000	1.000	1.000	1.000	1.000	1.000
1.500	1.500	1.500	1.500	1.500	1.500	1.500	1.500	1.500
12	12	12	12	12	12	12	12	12
100	125	160	200	250	315	400	630	800
Corrente nominale d'impiego le \ Rated operational current								
100	125	160	200	250	315	400	630	800
100	125	160	200	250	315	400	630	800
100	125	160	200	250	315	400	630	800
100	125	160	200	250	315	400	630	800
100	125	160	200	250	315	400	630	800
100	125	160	200	250	315	400	630	800
100	125	160	200	250	315	400	630	630
80	100	125	160	200	250	315	500	500
63	80	100	125	160	200	250	400	400
100	125	160	200	250	315	400	630	800
100	125	160	200	250	315	400	630	800
100	125	160	200	250	315	400	630	800
100	125	160	200	250	315	400	630	630
100	125	160	200	250	315	400	630	630
-	-	-	-	-	315	400	630	630
100	125	160	200	250	315	400	630	800
100	125	160	200	250	315	400	630	800
100	125	160	200	250	315	400	630	800
100	125	160	200	250	315	400	630	630
100	125	160	200	250	315	400	630	630
-	-	-	-	-	315	400	630	630
100	125	160	200	250	315	400	630	630
100	125	160	160	200	315	315	500	500
100	125	160	160	160	250	250	400	400
100	125	160	-	-	-	-	-	-
52	65	85	105	130	165	210	330	420
Corrente di corto circuito condizionata da fusibile \ Rated fuse short circuit current								
100	125	160	200	250	315	400	630	800
50	50	50	50	50	50	50	50	50
12	15	15	20	25	25	30	40	40
1.000*	1.250	1.600	2.000	2.500	3.150	4.000	6.300	8.000
800*	1.000	1.280	1.600	2.000	2.520	3.200	5.040	6.400
252	320	400	500	640	800	1.000	1.600	2.000
45	50	70	90	110	140	180	300	370
8000	8.000	8.000	7.000	7.000	7.000	7.000	4.000	4.000
1000	1.000	1.000	1.000	1.000	1.000	1.000	1.000	1.000
4,8	4,8	4,8	12	12	19,2	19,2	30	30
35	50	70	95	120	185	240	2X185	2X240
16X3	16X4	16X4	25X5	25X6	32X6	2x25x5	2X40X5	2X40X6
12	12	12	18	18	34	34	45	45
12	12	12	18	18	34	34	45	45
1,9	1,9	1,9	5	5	7	7	13	13
2	2	2	5,3	5,3	7,4	7,4	14,5	14,5

### VC1F

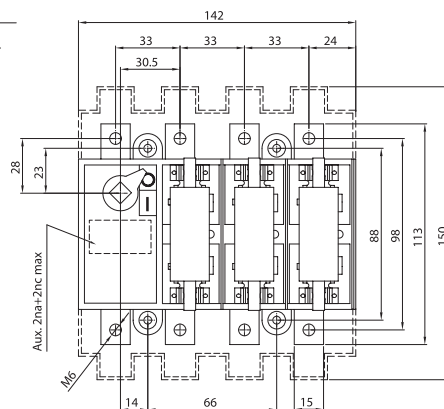
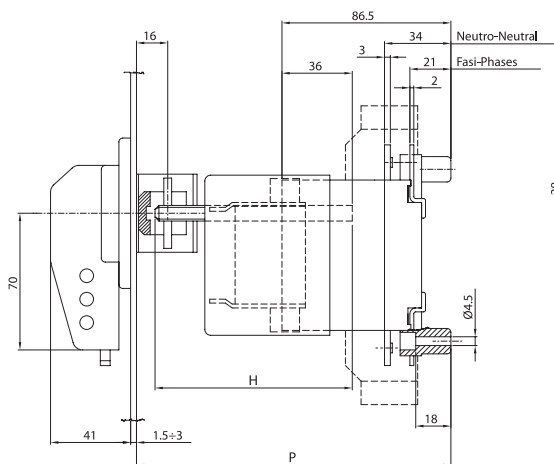
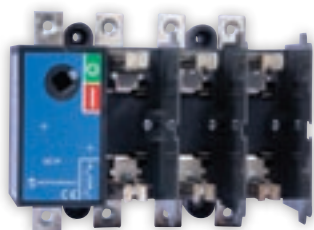

maniglia diretta \ direct handle

Foratura portella \ Door drilling

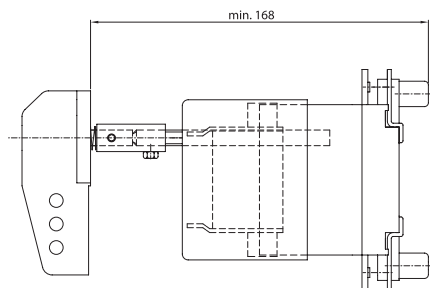
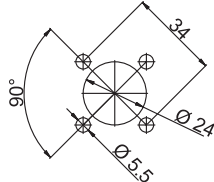

Legenda \ Caption

VC1F 32 ÷ 100 A

P		C	H
min	max	60,5	P-C
157,2	260,5		

C = costante \ constant

### VC2F

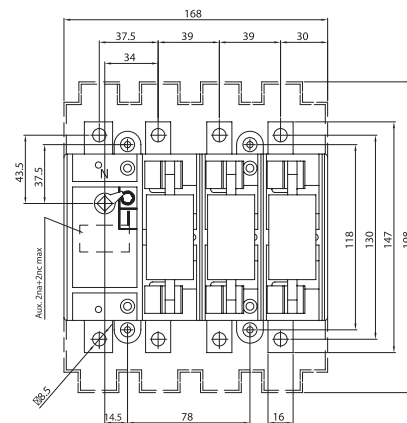
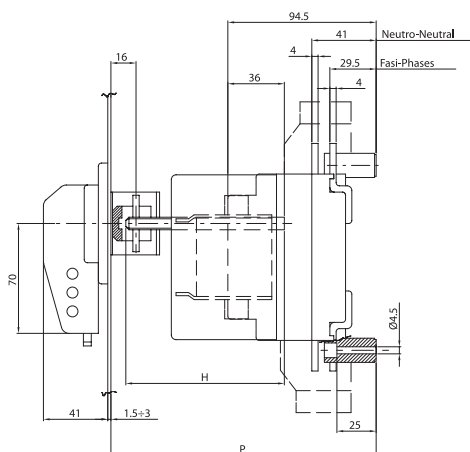
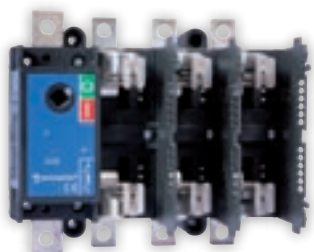

maniglia diretta \ direct handle

Foratura portella \ Door drilling

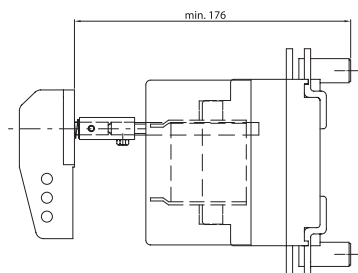
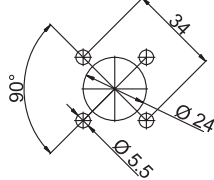

Legenda \ Caption

VC2F 100 ÷ 160 A

P		C	H
min	max	68,5	P-C
165,5	268,5		

C = costante \ constant

### VC3F

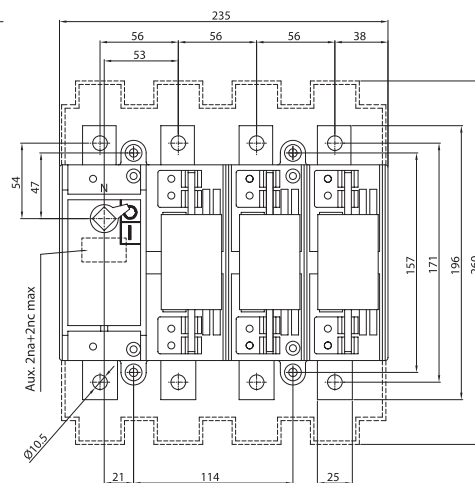
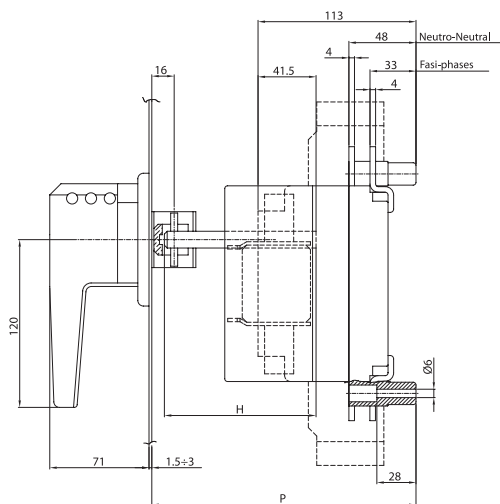

maniglia diretta \ direct handle

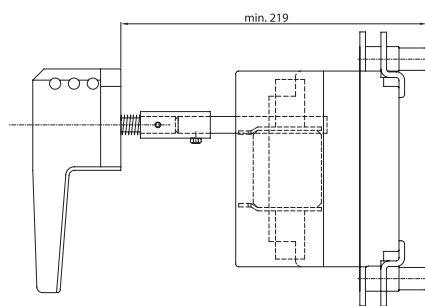

Foratura portella \ Door drilling

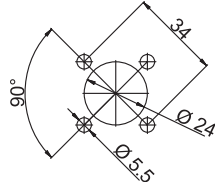

Legenda \ Caption

VC3F 200 ÷ 250 A

P		C	H
min	max		
189	280,5	71,5	P-C

C = costante \ constant

### VC4F

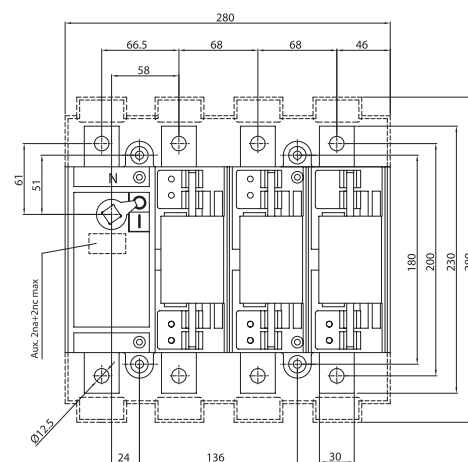
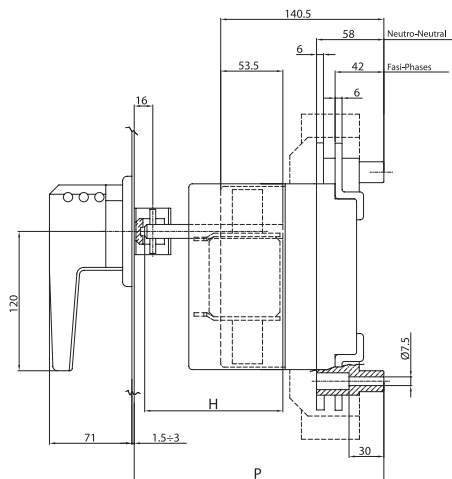

maniglia diretta \ direct handle

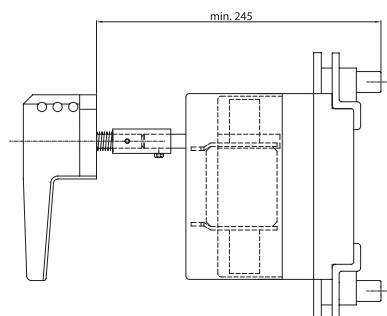

Foratura portella \ Door drilling

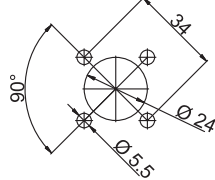

Legenda \ Caption

VC4F 315 ÷ 400 A

P		C	H
min	max		
215	296	96	P-C

C = costante \ constant

VC5F

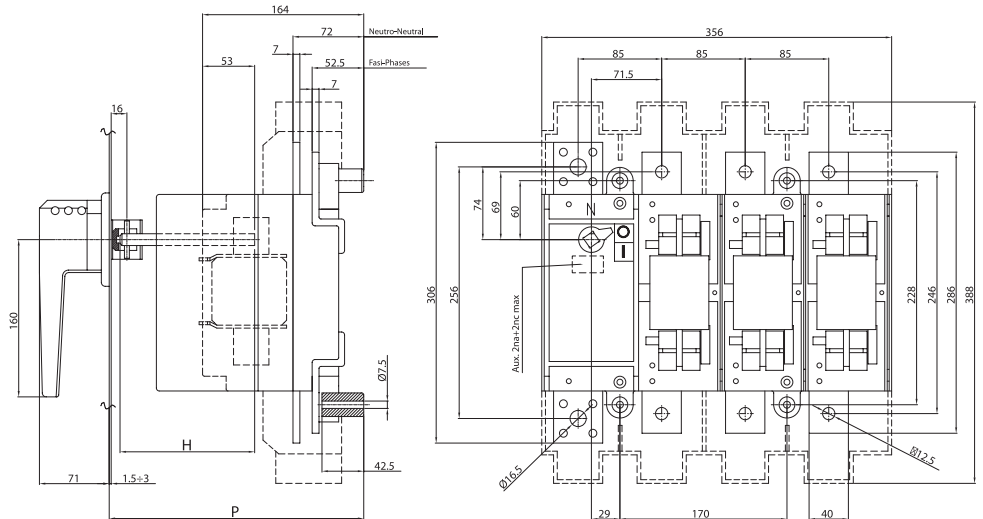

maniglia diretta \ direct handle

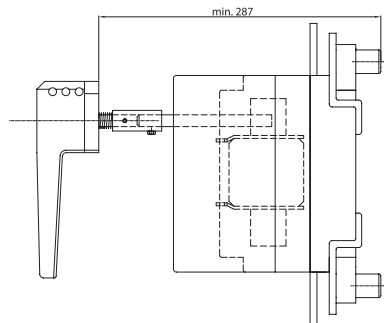

Foratura portella \ Door drilling

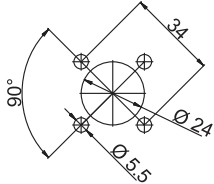

Legenda \ Caption

VC5F 630 ÷ 800 A

P		C	H
min	max		
257	320	120	P-C

C = costante \ constant

IMPIEGO E ABBINAMENTO DEI FUSIBILI A COLTELLO "UR DIN 43620" CON SEZIONATORI VISUAL COMPACT F STANDARD

L'abbinamento tra i sezionatori della serie VCF e i fusibili della serie UR a coltello pieno DIN 43620 consentono l'apertura o la chiusura sotto carico e il sezionamento di sicurezza, nonché la protezione di apparati elettronici di potenza (semiconduttori, raddrizzatori, inverter ecc.).

La possibilità d'impiego dei sezionatori standard consente un notevole risparmio economico e di gestione. Le prestazioni corrette si ottengono attenendosi scrupolosamente ai valori e modelli definiti dai nostri test, e riportati nella tabella di abbinamento fusibili UR Coltello DIN 43620 \ INT - SEZ VCF standard.

USE AND COMBINATION FUSES "UR KNIFE DIN 43620" AND STANDARD VCF SWITCHES

The combination between the switches VCF serie and fuses UR serie full knife DIN 43620 allow making and breaking operations under load and safety disconnector and protection of power electronic devices (semiconductors, rectifiers, inverters etc). The possibility of use of Standard switches allows remarkable economic saving and of management. The correct performances are obtained scrupulously following the values and types of our tests, showing in the combination table fuses UR knife DIN 43620 \ standard switch VCF.

Tabella di abbinamento dei fusibili UR a coltello pieno DIN 43620 e i sezionatori con porta fusibili standard VCF

Combination table fuses UR full knife DIN 43620 and standard switch VCF

Tipo sezionatore Switch type	Corrente nominale A Rated current A	Tipo Fusibile \ Fuse type UR DIN 43620 I max A	Taglia fusibile Size fuse
VC2F	100	40	NH00
VC2F	125	80/90	NH00-NH0
VC2F	160	100	NH00-NH0
VC3F	200	140	NH1
VC3F	250	170	NH1
VC4F	315	260	NH2
VC4F	400	290	NH2
VC5F	630	450	NH3
VC5F	800	500	NH3

Per ulteriori esigenze contattare TECHNOELECTRIC  
For other requests contact TECHNOELECTRIC





VCF con attacchi laterali

VCF with side connections



VC2F



VC3F

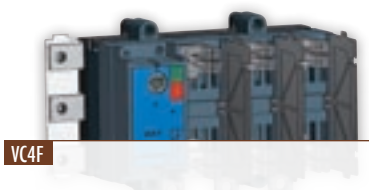

VC4F



VC5F

Tipo Type	Corrente nominale Rated current	Tipo di fusibile Type of fuse			Poli Poles	Attacchi laterali singoli Single side connections			Attacchi laterali doppi Double side connections		
		NFC	DIN	BS		NCF	DIN	BS	NCF	DIN	BS
Codice \ Code											
VC2F	125 A	22X58	NH 00	A4	3	▶ 12022	▶ 12042	▶ 12061	-	12042DS	12061DS
					4	▶ 12023	▶ 12052	▶ 12071	-	12052DS	12071DS
		-	NH 0	-	3	-	▶ 12044	-	-	12044DS	-
		-	NH 0	-	4	-	▶ 12054	-	-	12054DS	-
VC3F	160 A	-	NH 00	A4	3	-	▶ 12043	▶ 12062	-	12043DS	12062DS
					4	-	▶ 12053	▶ 12072	-	12053DS	12072DS
		-	NH 0	-	3	-	▶ 12045	-	-	12045DS	-
		-	NH 0	-	4	-	▶ 12055	-	-	12055DS	-
VC3F	250 A	-	NH 1	B1 + B2	3	-	▶ 13042	▶ 13062	-	13042DS	13062DS
					4	-	▶ 13052	▶ 13072	-	13052DS	13072DS
VC4F	400 A	-	NH 2	B1 + B2	3	-	▶ 14023	▶ 14043	-	14023DS	14043DS
					4	-	▶ 14033	▶ 14053	-	14033DS	14053DS
VC5F	630 A	-	NH 3	C1+C2	3	-	▶ 15020	▶ 15040	-	15020DS	15040DS
					4	-	▶ 15030	▶ 15050	-	15030DS	15050DS

▶ Per l'ordinazione aggiungere al termine del codice la desinenza secondo lo schema  
To order add the suffix to the code as per diagram

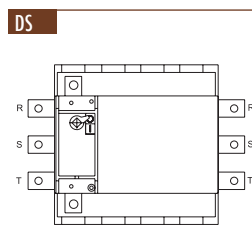
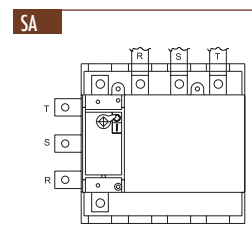
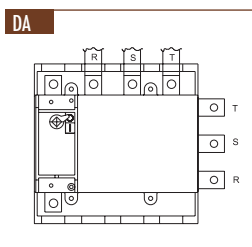
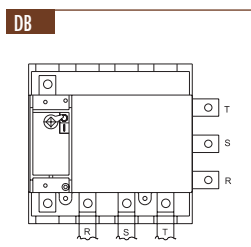
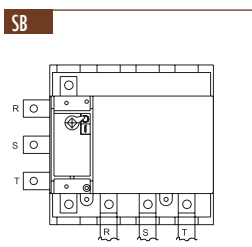

### VC2F

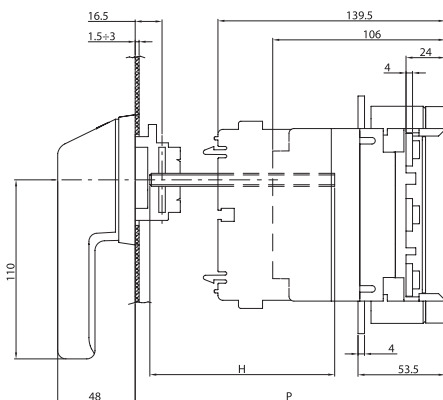
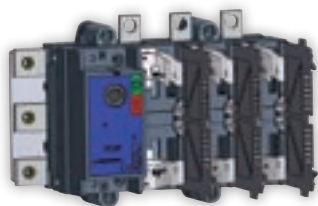

maniglia diretta \ direct handle

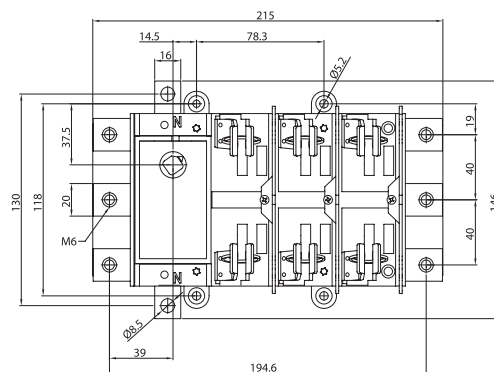

Foratura portella \ Door drilling

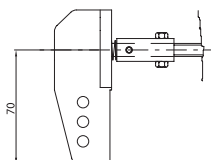
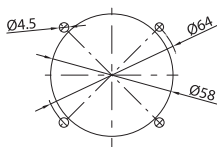

Legenda \ Caption

VC2F 125 ÷ 160 A

P		C	H
min	max		
177,5	280,5	68,5	P-C

C = costante \ constant

### VC3F

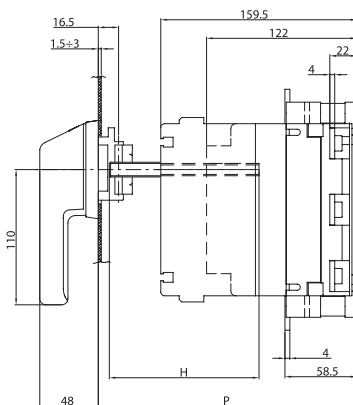

maniglia diretta \ direct handle

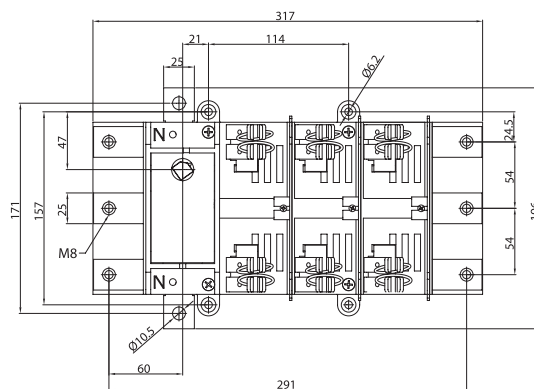

Foratura portella \ Door drilling

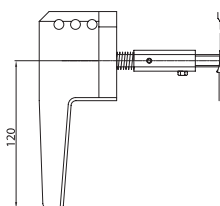
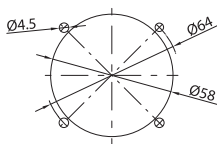

Legenda \ Caption

VC3F 200 ÷ 250 A

P		C	H
min	max		
209	300,5	71,5	P-C

C = costante \ constant

### VC4F

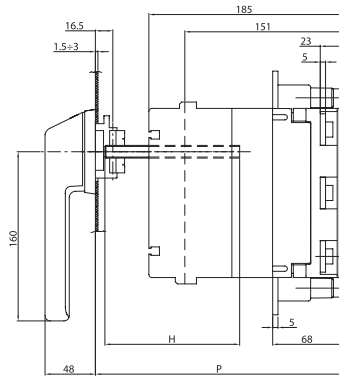
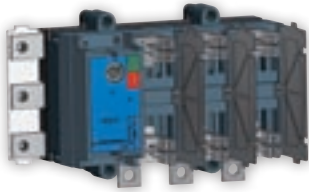

maniglia diretta \ direct handle

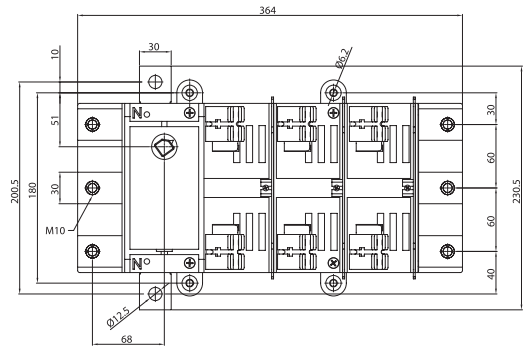
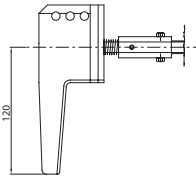

Foratura portella \ Door drilling

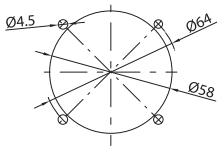

Legenda \ Caption

**VC4F 315 ÷ 400 A**

P		C	H
min	max		
225	306,5	96	P-C

C = costante \ constant

### VC5F

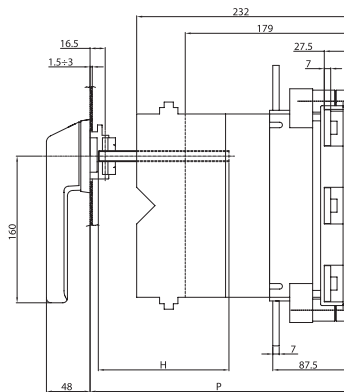
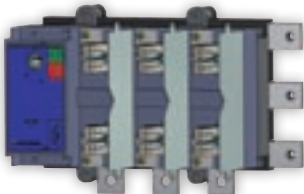

maniglia diretta \ direct handle

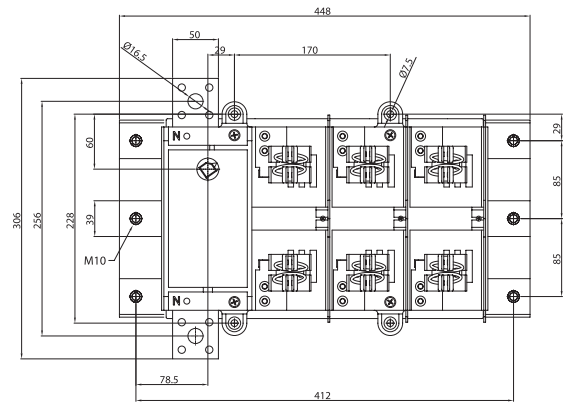
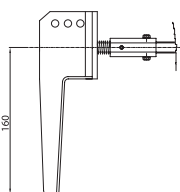

Foratura portella \ Door drilling

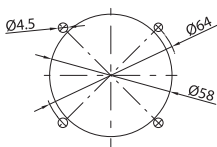

Legenda \ Caption

**VC5F 630 A**

P		C	H
min	max		
317	327		P-C

C = costante \ constant

## VISUALCOMPACT Fu | Ultra rapidi

### GENERALITA'

Gli interruttori della serie VISUALCOMPACT Fu sono una serie di interruttori di manovra sezionatori con porta fusibili del tipo T/80, T/110\* e BK50. L'impiego di questa serie consente la manovra in apertura e richiusura sotto carico e il sezionamento di sicurezza. L'abbinamento con gli specifici fusibili, consente la protezione di apparati elettronici di potenza (semi-conduttori, raddrizzatori, inverter ecc.).

### NOTE TECNICHE

Le tipologie di fusibili da noi indicate, DIN 43653 T/80 e T/110, BK50 rappresentano la migliore associazione tecnica tra il nostro interruttore e il fusibile ultra rapido. Per ulteriori esigenze di abbinamento o di portate maggiori prego consultarci.

\*Fusibili T/110 a richiesta.



VC2Fu



VC3Fu

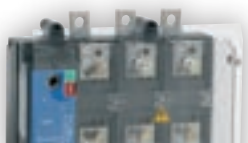

VC4Fu



VC5Fu

## VISUALCOMPACT Fu | Ultra rapid

### GENERALITIES

The VISUALCOMPACT Fu series is a range of switch disconnectors fuse with fuse holders of T/80, T/110\* and BK50 type. The use of this series allows making and breaking operations under load and safety disconnection. With suitable fuses, it allows the protection of power electronic devices (semiconductors, rectifiers, inverters etc.).

### TECHNICAL NOTES

BK50, T/80 and T/110 DIN 43653 types of fuses represent the best technical combination between Visualcompact Fu switches and ultra rapid fuses.

For other types of combinations or higher current please contact us.

\*Fuses T/110 on demande.

Tipo Type	Corrente nominale Rated current	Tipo fusibile \ Fuse type		Poli Poles	Senza maniglia \ Without handle	
		DIN 43653			Codice \ Code	
VC2Fu	40 A	T80-00		3	12041U	
		T80-00		4	12051U	
	80 A	T80-00		3	12042U	
		T80-00		4	12052U	
	90 A	T80-00		3	12043U	
		T80-00		4	12053U	
VC3Fu	100 A	T80-00		3	12044U	
		T80-00		4	12054U	
	140 A	T80-00		3	13041U	
		T80-00		4	13051U	
VC4Fu	170 A	T80-00		3	13042U	
		T80-00		4	13052U	
VC5Fu	260 A	T80-00		3	14022U	
		T80-00		4	14032U	
	290 A	T80-00		3	14023U	
		T80-00		4	14033U	
	500 A	BK50 - 2		3	15020U	
		BK50 - 2		4	15030U	
BK50 - 2		3	15021U			
BK50 - 2		4	15031U			

Tipo \ Type	Maniglia diretta \ Direct handle	Maniglia blocco porta \ Door interlock handle
VC2Fu	18081	18001
VC3Fu	18083	18003
VC4Fu	18083	18003
VC5Fu	18084	18005





## FBA visualcompact con dispositivo di apertura

### GENERALITA'

Gli interruttori della serie VISUALCOMPACT FBA sono 3 - 4 poli con comando manuale, corredati di un comando di apertura locale per mezzo di maniglia a distanza tramite bobina a lancio di corrente alimentata dall'esterno.

## FBA visualcompact with tripping device

### GENERALITIES

The switch disconnectors VISUALCOMPACT FBA are 3 - 4 poles manually operated and are switches supplied with a remote tripping device by means of a current shot coil.

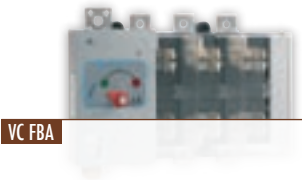

Tipo Type	Corrente nominale Rated current	Poli Poles	V aux. bobina \ V aux coil				
			24 V c.c. \ DC	48 V c.c. \ DC	110 V c.c. \ DC	110 V c.a. \ AC	220 V c.a. \ AC
VC4F BA	250 A	3	14021B	14021B1	14021B2	14021B3	14021B4
		4	14031B1	14031B1	14031B2	14031B3	14031B4
	315 A	3	14022B	14022B1	14022B2	14022B3	14022B4
		4	14032B	14032B1	14032B2	14032B3	14032B34
	400 A	3	14023B	14023B1	14023B2	14023B3	14023B4
		4	14033B	14033B1	14033B2	14033B3	14033B4
VC5F BA	630 A DIN	3	15020B	15020B1	15020B2	15020B3	15020B4
		4	15030B	15030B1	15030B2	15030B3	15030B4
	630 A BS	3	15040B	15040B1	15040B2	15040B3	15040B4
		4	15050B	15050B1	15050B2	15050B3	15050B4
	800 A DIN	3	15022B	15022B1	15022B2	15022B3	15022B4
		4	15032B	15032B1	15032B2	15032B3	15032B4
	800 A BS	3	15041B	15041B1	15041B2	15041B3	15041B4
		4	15051B	15051B1	15051B2	15051B3	15051B4

› Versione per fusibile BS a richiesta  
BS version available on request

I codici sopracitati non comprendono la maniglia di manovra e la prolunga albero di comando  
The below codes do not include door interlock handle and extension shaft

## ACCESSORI \ ACCESSORIES



18856



18856

Tipo Type	Maniglia blocco porta Door interlock handle	Maniglia diretta Direct handle
150 (mm)	18856	18857



Prolunga albero comando Extension shaft	Codice Code
100 (mm)	18032
200 (mm)	18035
300 (mm)	18038

### VC4F BA

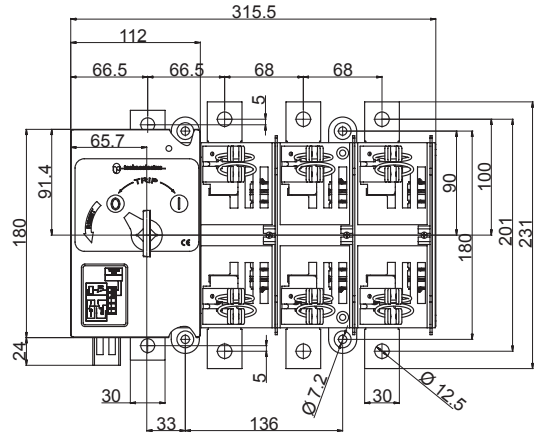
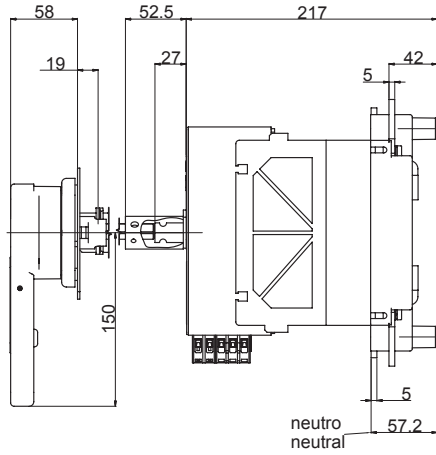
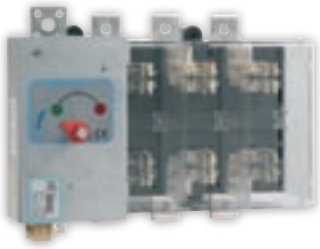

Foratura portella \ Door drilling

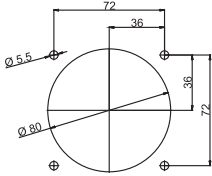

### VC5F BA

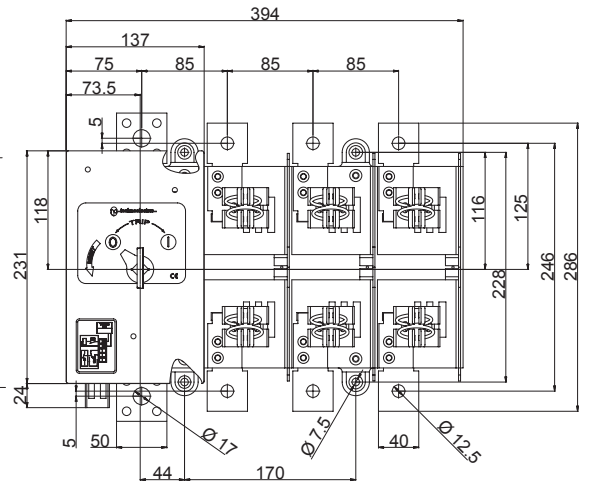
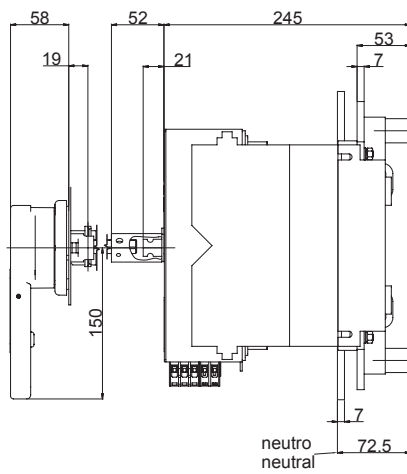

### Schema morsettiera \ Terminal board diagram

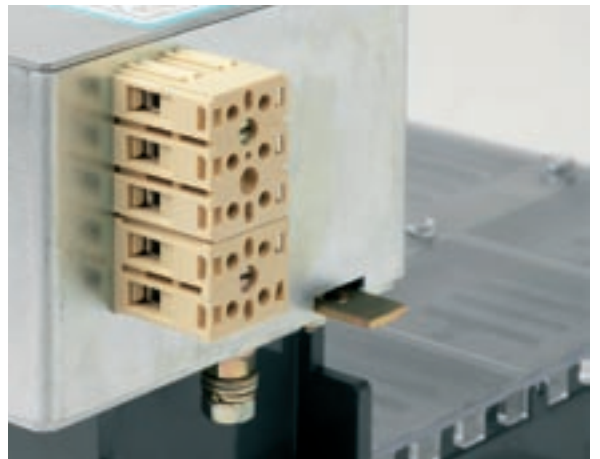
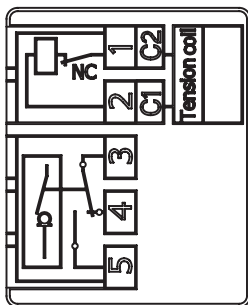



## VISUALCOMPACT VCF - MS Interruttori di manovra a comando motorizzato

### GENERALITÀ

La nuova serie VISUALCOMPACT F MS consta di interruttori-sezionatori motorizzati a 3 - 4 poli con porta fusibili. Assicura, attraverso un comando a distanza, manovre di apertura e chiusura sotto carico in sistemi e impianti di bassa tensione.

### CARATTERISTICHE GENERALI

Le caratteristiche tecniche degli interruttori di manovra sezionatori impiegati nei VISUALCOMPACT F MS sono rispondenti a quanto riportato nei capitoli riguardanti la serie VISUALCOMPACT F.

- ▶ manovra manuale d'emergenza (0-1 e 1-0) con maniglia a corredo
- ▶ blocco meccanico di sicurezza lucchettabile, in posizione 0 interdice la manovra elettrica e manuale
- ▶ visualizzazione meccanica e luminosa (led) della pos 0,1
- ▶ segnalazione esterna della posizione tramite contatto AUX (vedi morsettiera)
- ▶ tempo di manovra (0-1 o 1-0) 1,5 sec
- ▶ alimentazione aux. 12/24 VCC 110/220/380 VCA
- ▶ temperatura ambiente di funzionamento - 20°C + 40°C

### CONFORMITÀ ALLE NORME

IEC 60947-1 IEC 60947-3 | CEI EN 60947-1 | CEI EN 60947-3  
VDE 0660 Teil 107



VC FMS

## VISUALCOMPACT VCF - MS Motorized load break switches

### GENERALITIES

The new series VISUALCOMPACT F MS are 3 - 4 poles load break switches and fuse load break switches. They allow making and breaking operations of low voltage system under load by control.

### GENERAL CHARACTERISTICS

The technical characteristics of the load break switches used in the VISUALCOMPACT F MS are correspondent to as shown in the chapter of VISUALCOMPACT F series.

- ▶ emergency manual operation (0-1 and 1-0) by means of equipped handle
- ▶ emergency padlockable mechanical block of electrical and manual operation in 0 position
- ▶ mechanical and illuminated indication (led) of position 0,1
- ▶ external input of position segnalization by auxiliary contacts (see terminal board diagram)
- ▶ 0-1 or 1-0 operating time 1,5 sec.
- ▶ supply voltages 12/24V DC, 110/220/380V AC
- ▶ working ambient temperature from - 20°C + 40°C

### CONFORMITY TO STANDARDS

IEC 60947-1 IEC 60947-3 | CEI EN 60947-1 | CEI EN 60947-3  
VDE 0660 Teil 107

Tipo \ Type	Corrente nominale \ Rated current	Poli \ Poles	Codice \ Code
VC2F MS	100 A	3	12041MS
		4	12051MS
	125 A	3	12042MS
		4	12052MS
160 A	3	12043MS	
	4	12053MS	
VC3F MS	200 A	3	13041MS
		4	13051MS
	250 A	3	13042MS
		4	13052MS
VC4F MS	315 A	3	14022MS
		4	14032MS
	400 A	3	14023MS
		4	14033MS
VC5F MS	630 A	3	15020MS
		4	15030MS
	800 A	3	15041MS
		4	15051MS

▶ Per i fusibili da impegnare vedere pag II-5  
For the fuses to use, see page II-5

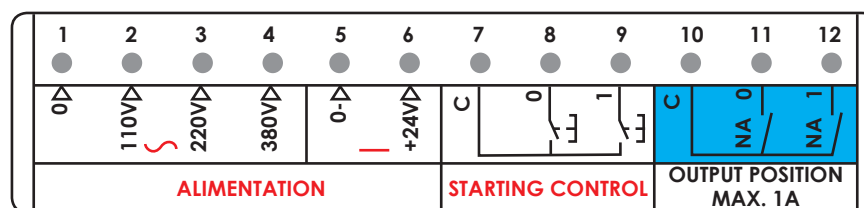

### VC2F MS

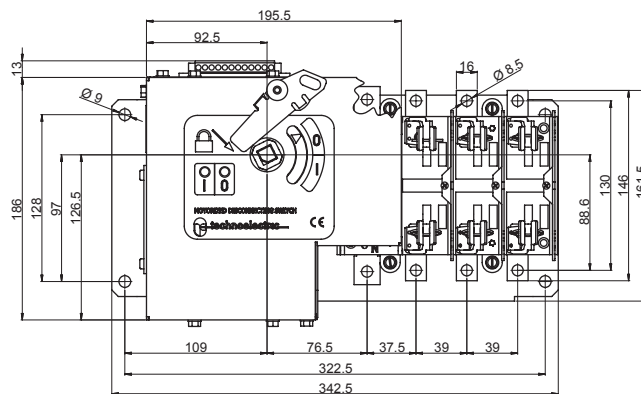
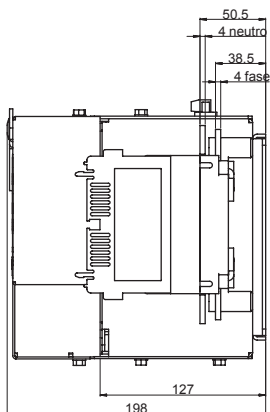
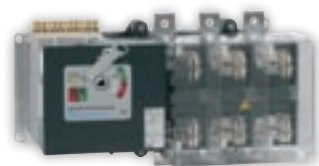

### VC3F MS

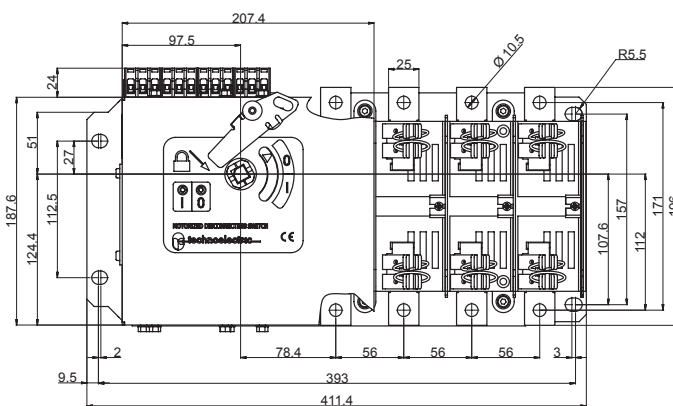
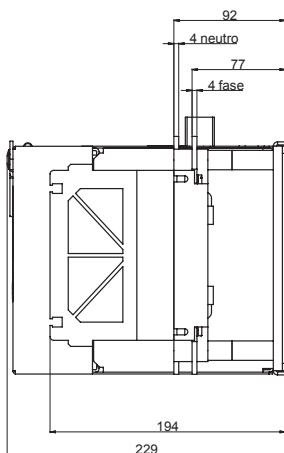
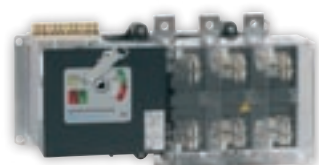



EOF



E01F

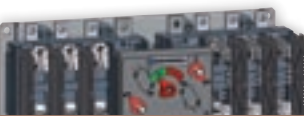

E02F



E03F

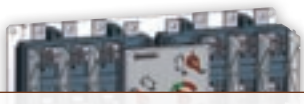

E04F

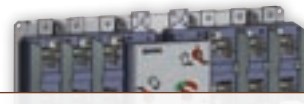

E05F

Tipo Type	Corrente nominale Rated current	Tipo fusibile Fuse type DIN	Poli Poles	Con maniglia blocco porta With door interlock handle Codice \ Code	Senza maniglia Without handle Codice \ Code	
E01F	32 A	NHC 00	6	110406	110406SM	
		NHC 00	8	110506	110506SM	
	45 A	NHC 00	6	110416	110416SM	
		NHC 00	8	110516	110516SM	
	63 A	NHC 00	6	110426	110426SM	
		NHC 00	8	110526	110526SM	
	80 A	NHC 00	6	110436	110436SM	
		NHC 00	8	110536	110536SM	
	100 A	NHC 00	6	110446	110446SM	
		NHC 00	8	110546	110546SM	
	E02F	100 A	NH 00	6	120416	120416SM
			NH 00	8	120516	120516SM
125 A		NH 00	6	120426	120426SM	
		NH 00	8	120526	120526SM	
160 A		NH 00	6	120436	120436SM	
		NH 00	8	120536	120536SM	
125 A		NH 0	6	120446	120446SM	
		NH 0	8	120546	120546SM	
160 A		NH 0	6	120456	120456SM	
		NH 0	8	120556	120556SM	
E03F		200 A	NH 1	6	130416	130416SM
			NH 1	8	130516	130516SM
	250 A	NH 1	6	130426	130426SM	
		NH 1	8	130526	130526SM	
	315 A	NH 2	6	140226	140226SM	
		NH 2	8	140326	140326SM	
400 A	NH 2	6	140236	140236SM		
	NH 2	8	140336	140336SM		
E05F	630 A	NH 3	6	150206	150206SM	
		NH 3	8	150306	150306SM	
	800 A	NH 3	6	150226	150226SM	
		NH 3	8	150326	150326SM	

# E01F

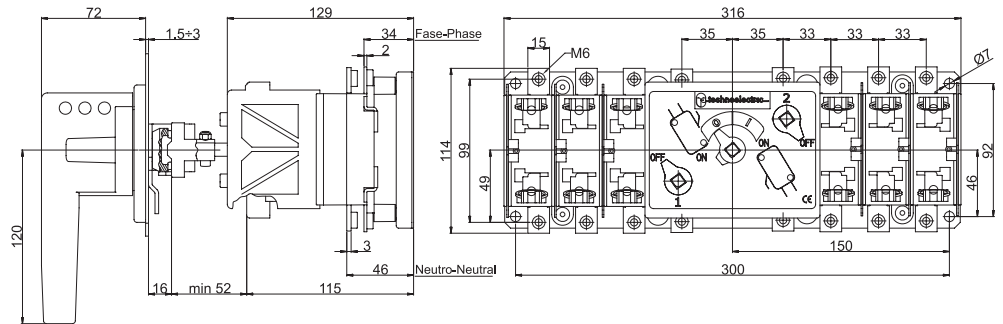

Foratura portella \ Door drilling

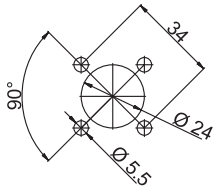

# E02F

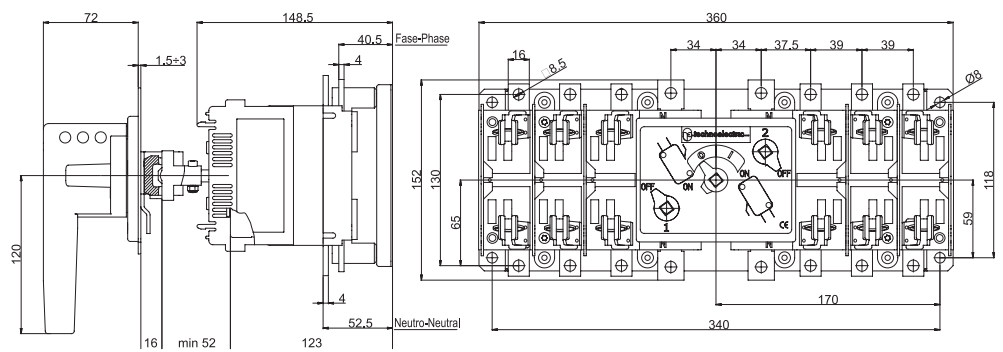
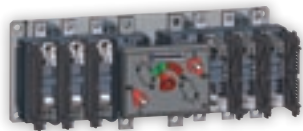

Foratura portella \ Door drilling

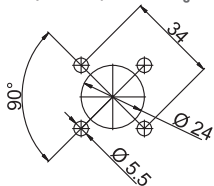

# E03F

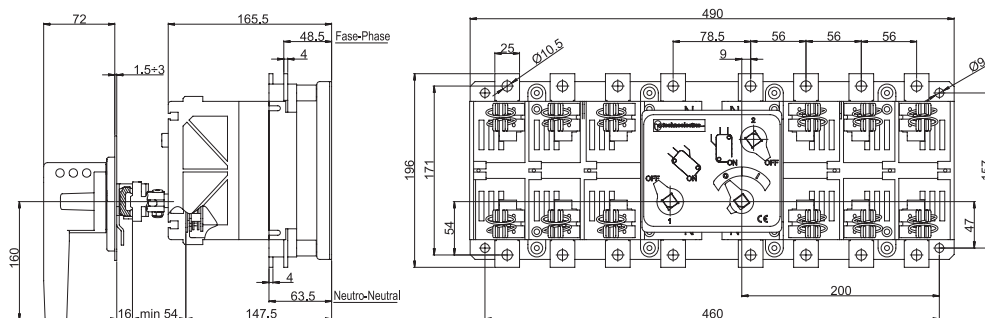

Foratura portella \ Door drilling

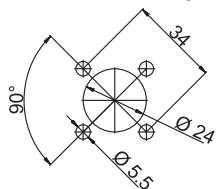

# E04F

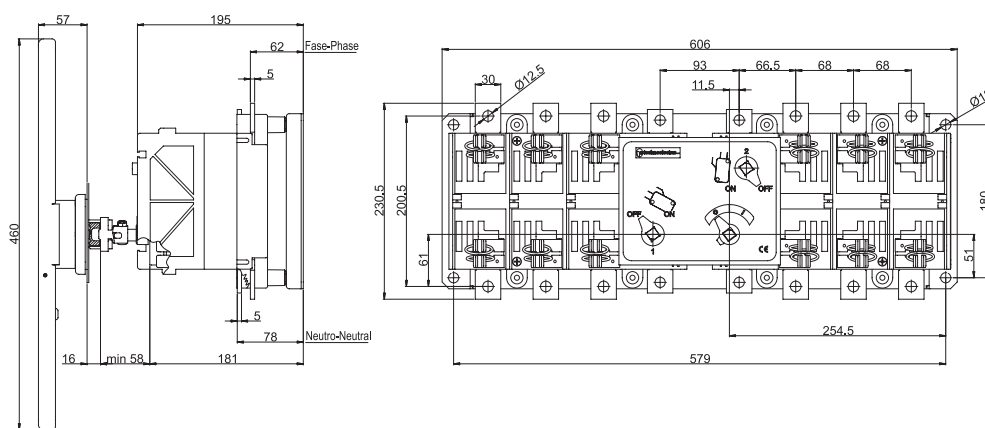

Foratura portella \ Door drilling

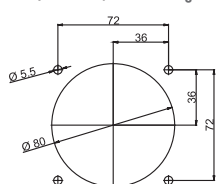

# E05F

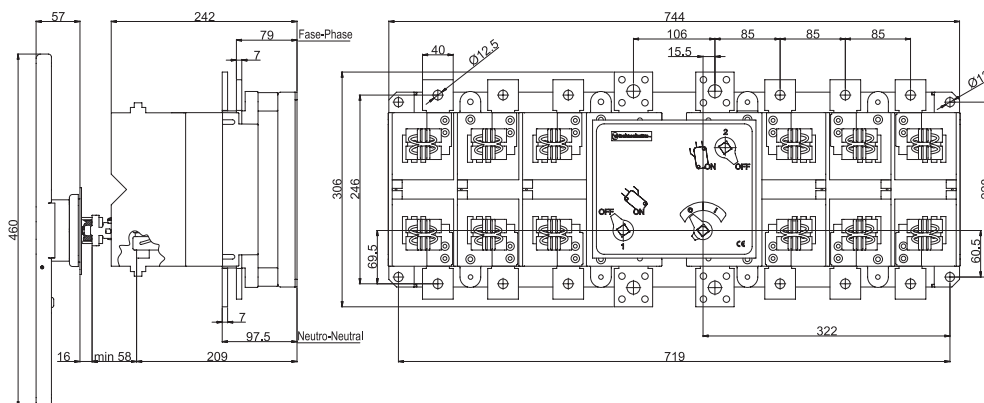

Foratura portella \ Door drilling

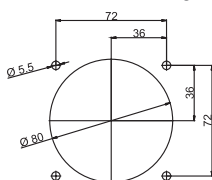

maniglia blocco porta \ door interlock handle

Tipo \ Type	Poli \ Poles	VC1F	VC2F	VC3F	VC4F	VC5F
Codice \ Code	3   4	18001	18001	18003	18003	18005   18007
Codice \ Code	6   8	18003	18003	18005	18005	18830   18844



maniglia blocco porta di emergenza \ red \ yellow door interlock handle

Tipo \ Type	Poli \ Poles	VC1F	VC2F	VC3F	VC4F	VC5F
Codice \ Code	3   4	18002	18002	18004	18004	18006   18008
Codice \ Code	6   8	18004	18004	18006	18006	18831   18847

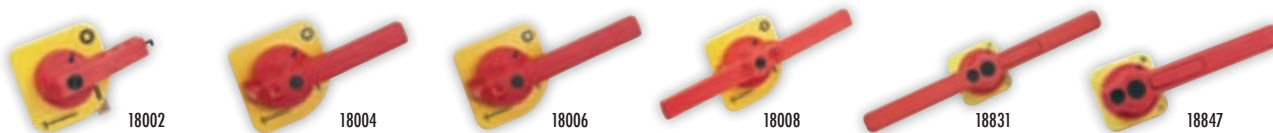

albero comando 200 mm \ shaft 200 mm

Tipo \ Type	VC1F	VC2F	VC3F	VC4F	VC5F
Codice \ Code	18201	18201	18207	18207	18207

albero comando 300 mm \ shaft 300 mm

Tipo \ Type	VC1F	VC2F	VC3F	VC4F	VC5F
Codice \ Code	18202	18202	18208	18208	18208

albero comando 400 mm \ shaft 400 mm

Tipo \ Type	VC1F	VC2F	VC3F	VC4F	VC5F
Codice \ Code	18203	18203	18209	18209	18209



prolunga albero 100 mm \ extension shaft 100 mm

Tipo \ Type	EOF 1   2	EOF 3   4   5
Codice \ Code	18030	18032

prolunga albero 200 mm \ extension shaft 200 mm

Tipo \ Type	EOF 1   2	EOF 3   4   5
Codice \ Code	18033	18035

prolunga albero 300 mm \ extension shaft 300 mm

Tipo \ Type	EOF 1   2	EOF 3   4   5
Codice \ Code	18036	18038





maniglia diretta \ direct handle

Tipo \ Type	VC1F	VC2F	VC3F	VC4F	VC5F
Codice \ Code	18190	18191	18390	18193	18194   18195

Fornita completa di schermo protezione fusibili  
Supplied with fuses cover



18190 - 18191



18390



18193 - 18194



18195



maniglia diretta \ direct handle

Tipo \ Type	E01F	E02F	E03F	E04F	E05F
Codice \ Code	18594	18595	18597	18598	18599

Fornita completa di due schermi protezione fusibili  
Versione lucchettabile fornibile a richiesta

With two fuses cover  
Patlockable version on request

blocco lucchetto per maniglia diretta \ padlock for direct handle

Tipo \ Type	VC1F	VC2F	VC3F	VC4F	VC5F
Codice / Code	18240	18241	18242	18243	18244



maniglia blocco porta con blocco chiave \ door interlock handle with key lock

Tipo / Type	VC1F	VC2F	VC3F	VC4F	VC5F
Codice / Code	18100	18100	18100	18100	18102/18104



18100



18102



18104

maniglia blocco porta con dispositivo di sblocco con attrezzo speciale \ door interlock handle with defeater mechanism (special tool)

Tipo / Type	VC1P	VC2P	VC3P	VC4P	VC5P
Codice / Code	18220	18220	18222	18222	18224



18220



18222



18224

maniglia blocco porta di emergenza con dispositivo di sblocco con attrezzo speciale \ red/yellow door interlock handle with defeater mechanism (special tool)

Tipo \ Type	VC1F	VC2F	VC3F	VC4F	VC5F
Codice \ Code	18221	18221	18223	18223	18225



18221



18223



18225

maniglia blocco porta emergenza con doppia funzione di sicurezza \ door interlock handle/emergency with double function of security handle

Tipo \ Type	VC1F	VC2F	VC3F	VC4F	VC5F
Codice \ Code	18234   18235 ●	18234   18235 ●	18234   18235 ●	18236   18237 ●	18236   18237



18234



18236



18235



18237

Adatta per montaggio su portella con dispositivo di blocco porta in posizione On  
Grado di protezione IP 65

Disponibile anche nella versione per emergenza (rosso\gialla)

For door mounting with Door interlocking in "On" position

IP 65 degree of protection

Available also for emergency operation (red\yellow)

Foratura portella \ Door drilling

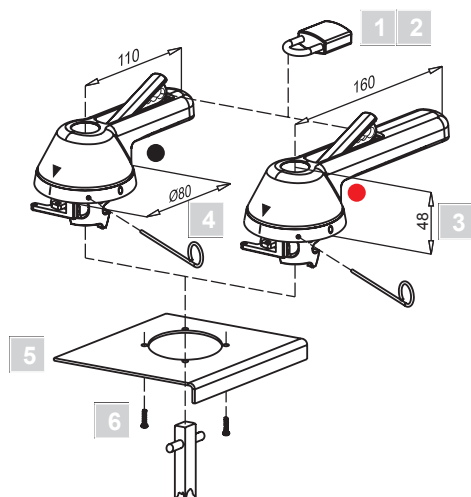
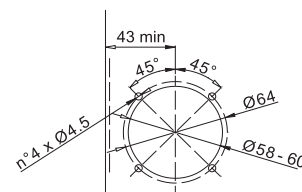

1	Lucchettabile (max 3 lucchetti 1xØ8+2xØ6) in posizione Off.	Padlockable in "Off" position (with max 3 padlocks of 1xØ8+2xØ6).
2	Apertura della portella impedita quando la maniglia è lucchettata in posizione di Off.	Door opening is prevented when the handle is padlocked in "Off" position.
3	Ingombro inferiore a 50 mm in profondità per permettere l'utilizzo anche in quadri a doppia portella.	Handle height less than 50 mm for suitability with two-doors type panels.
4	Permette, a mezzo di un apposito attrezzo, fornito con la maniglia, l'esclusione del dispositivo di blocco porta e quindi l'apertura della portella anche a interruttore in posizione di ON. Il dispositivo bloccoporta si ripristina automaticamente al chiudersi della porta.	With the use of the special tool (supplied), the door interlock mechanism can be bypassed maintaining the switch in the "On" position and the door can be opened. The door interlocking mechanism is automatically re-established on closing door.
5	Può essere montata su portelle di qualsiasi spessore.	Can be mounted on doors of any thickness.
6	Posizione della maniglia fissa quando la portella è aperta.	Position of fixed handle when the door is open.



contatti ausiliari in scambio 1NA + 1NC per apertura anticipata  
auxiliary changeover contacts 1NO + 1NC activated before main contacts

Tipo \ Type	VC1F	VC2F	VC3F	VC4F	VC5F
Codice \ Code	18165	18165	18163	18160	18163

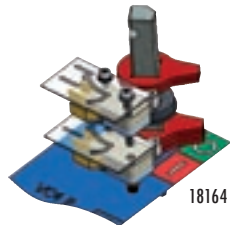
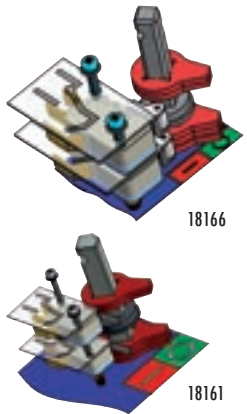

contatti ausiliari in scambio 2NA + 2NC per apertura anticipata  
auxiliary changeover contacts 2NO + 2NC activated before main contacts

Tipo \ Type	VC1F	VC2F	VC3F	VC4F	VC5F
Codice \ Code	18166	18166	18164	18161	18164



contatti ausiliari in scambio 1NA + 1NC per apertura posticipata  
auxiliary changeover contacts 1NO + 1NC activated after main contacts

Tipo \ Type	VC1F	VC2F	VC3F	VC4F	VC5F
Codice \ Code	18120	18120	18127	18127	18127



contatti ausiliari in scambio 2NA + 2NC per apertura posticipata  
auxiliary changeover contacts 2NO + 2NC activated after main contacts

Tipo \ Type	VC1F	VC2F	VC3F	VC4F	VC5F
Codice \ Code	18123	18123	18128	18128	18128

Contatti ausiliari in scambio  
Apertura anticipata rispetto all'apertura dei contatti principali dell'interruttore  
Portata nominale 16A  
Portata termica 20A

Change over auxiliary contact  
Break before main contacts switches  
Rated current 16A  
Thermal current 20A

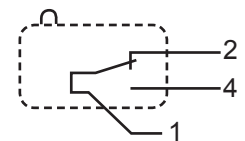
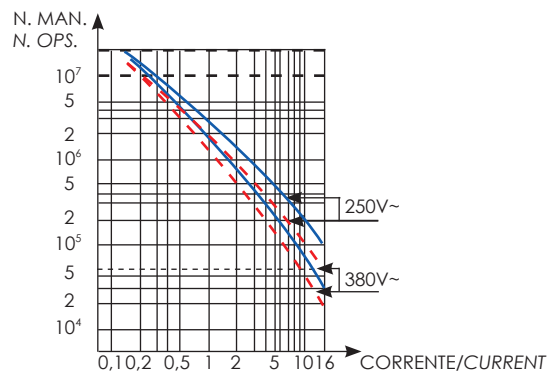

Codici per l'ordinazione per interruttori 6-8 poli  
Order references for switch 6-8 poles



paletta  
lever

contatti ausiliari in scambio 1NA+1NC \ auxiliary changeover contacts 1NO+1NC

Tipo \ Type	E01F	E02F
Codice \ Code	18566	(paletta / lever)



rotella  
roller

contatti ausiliari in scambio 1NA+1NC \ auxiliary changeover contacts 1NO+1NC

Tipo \ Type	E03F - E04F - E05F
Codice \ Code	18560 (rotella / roller)

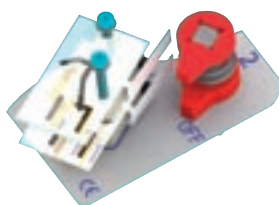

contatti ausiliari in scambio 2NA+2NC \ auxiliary changeover contacts 2NO+2NC

Tipo \ Type	E01F	E02F
Codice \ Code	18568	



contatti ausiliari in scambio 2NA+2NC \ auxiliary changeover contacts 2NO+2NC

Tipo \ Type	E03F - E04F - E05F
Codice \ Code	18567

Esempi di montaggio  
Mounting example

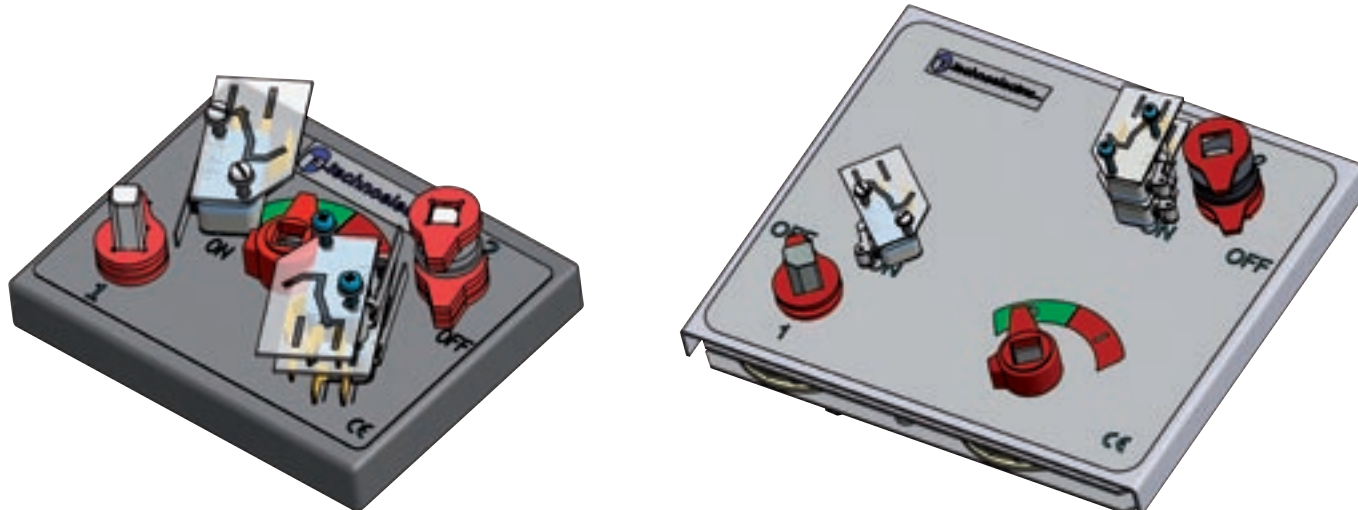

calotta protezione terminali superiori \ upper terminal cover



Tipo \ Type	VC1F	VC2F	VC3F	VC4F	VC5F
Codice \ Code	18050	18052	18350	18054	18056

calotta protezione terminali inferiori \ lower terminal cover



Tipo \ Type	VC1F	VC2F	VC3F	VC4F	VC5F
Codice \ Code	18051	18053	18351	18055	18057

schermo protezione fusibili \ fuses cover



Tipo \ Type	VC1F	VC2F	VC3F	VC4F	VC5F
Codice \ Code	18180	18181	18380	18183	18184

dispositivo di segnalazione intervento fusibili \ fuse melting detector



Tipo \ Type	VC1F	VC2F	VC3F	VC4F	VC5F	Cod	Aux
Codice \ Code			18200   ...			18200-1	110-380 Vca/V AC
						18200-2	380-660 Vca/V AC
						18200-3	24 Vcc/V DC
						18200-4	48 Vcc/V DC
						18200-5	60 Vcc/V DC
						18200-6	110 Vcc/V DC
						18200-7	220-440 Vcc/V DC

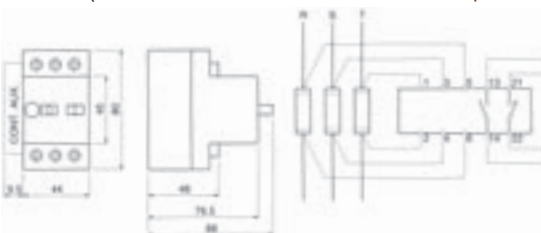

-20°C In x 0.80  
 0°C In x 0.90  
 +10°C In x 0.96  
 +20°C In x 1.00  
 +30°C In x 1.05  
 +40°C In x 1.12  
 +50°C In x 1.20  
 +60°C In x 1.30

spessore rialzo \ risers



Tipo \ Type	VC1F	VC2F	VC3F	VC4F	VC5F
Codice \ Code	18290	18291	18292	18293	18293

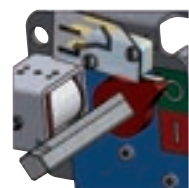
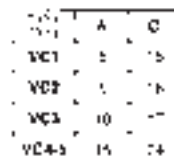

cod 18298

contatti ausiliari in scambio 1NA + 1NC per apertura posticipata  
 auxiliary changeover contacts 1NO + 1NC activated before main contacts



cod 18299

contatti ausiliari in scambio 2NA + 2NC per apertura posticipata  
 auxiliary changeover contacts 1NO + 1NC activated before main contacts



blocco manovra elettrico \ electric interlock

Tipo \ Type	Tensione Voltage	VC2F	VC3F	VC4F	VC5F
Cod \ Code	24 V dc	18119B	18117B	18116B	18115B
Cod \ Code	230 V ac	18119B4	18117B4	18116B4	18115B4

altre tensioni a richiesta / further versions upon request

Dispositivo di sicurezza adatto per il montaggio su interruttori di manovra sezionatori VC2-3-4-5-6P. Impedisce la manovra quando l'interruttore è in posizione Off. La manovra da Off a On è consentita solo alimentando la bobina.

La bobina deve essere alimentata solo per il tempo necessario alla manovra. Disponibili nelle versioni con bobina 24 V dc oppure 220 V ac. A richiesta può essere fornito un dispositivo per blocco sia in posizione On che in posizione Off.

Safety device suitable for mounting on switch disconnectors VC2-3-4-5-6P. It prevents the switch to operate when it is in Off position. The operation from Off to On is possible when the coil is energised only. The coil can remain energised just for the time needed for the operation. Available with 24 V dc or 220 V ac coil. On request, a device for locking in both positions Off and On can be supplied.

Maniglia nera \ Black handle 18001 | 18220  
 Maniglia rossa \ Red handle 18002 | 18221

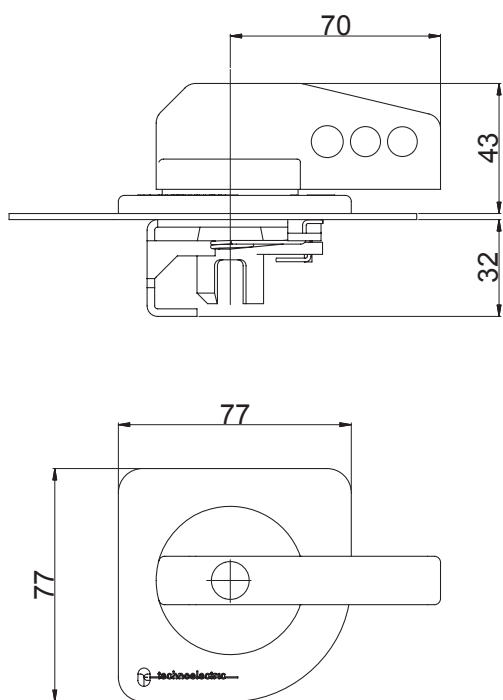

Maniglia nera \ Black handle 18003 | 18100 | 18222  
 Maniglia rossa \ Red handle 18004 | 18223

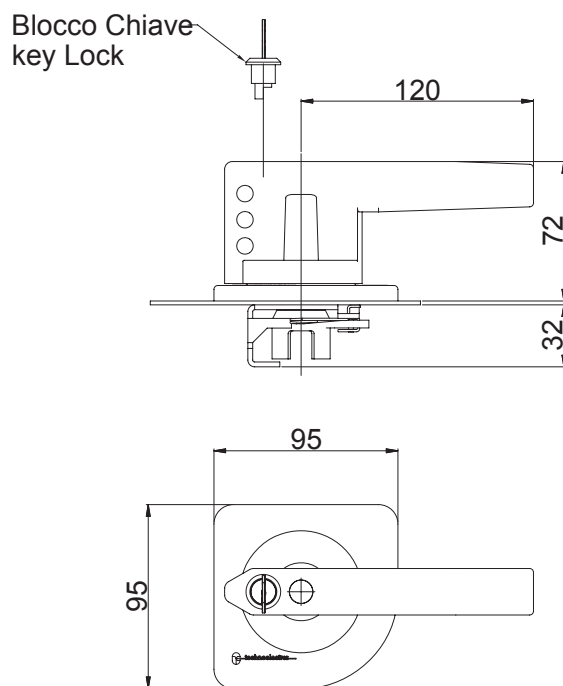

Maniglia nera \ Black handle 18005 | 18102 | 18224  
 Maniglia rossa \ Red handle 18006 | 18225

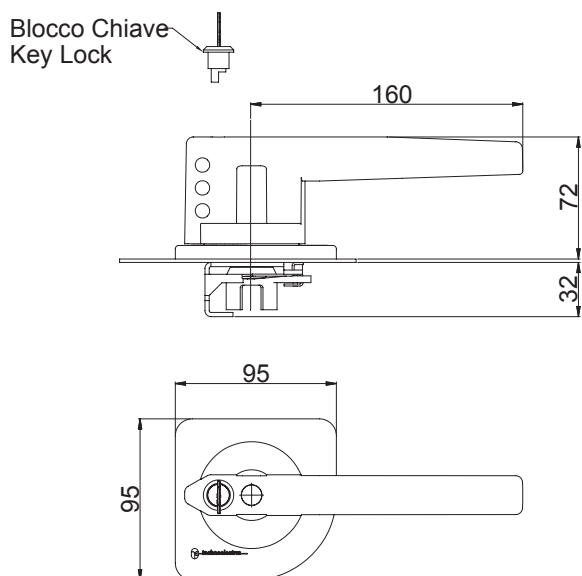

Maniglia nera \ Black handle 18007 | 18104 | 18226  
 Maniglia rossa \ Red handle 18008 | 18227

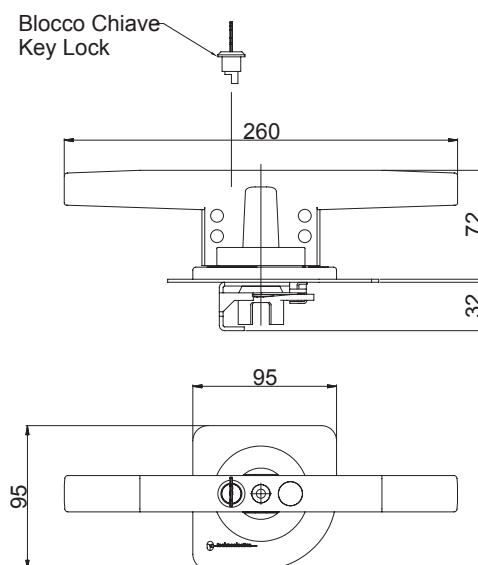

Maniglia nera \ Black handle 18020 | 18021 | 18190 | 18191

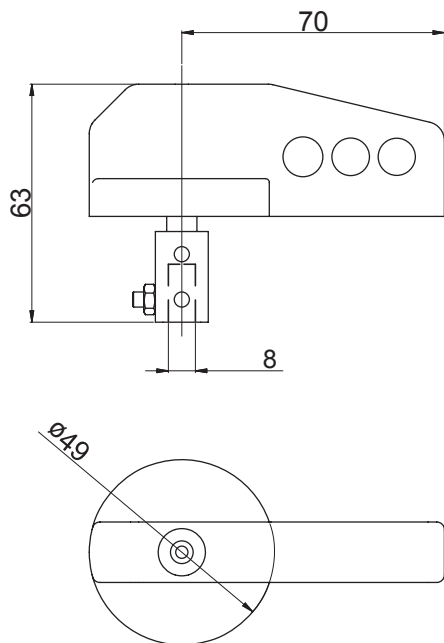

Maniglia nera \ Black handle 18022 | 18083 | 18193 | 18320 | 18390

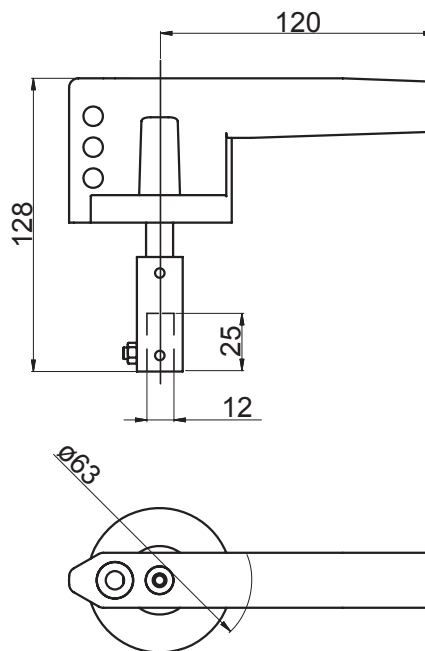

Maniglia nera \ Black handle 18023 | 18084 | 18194

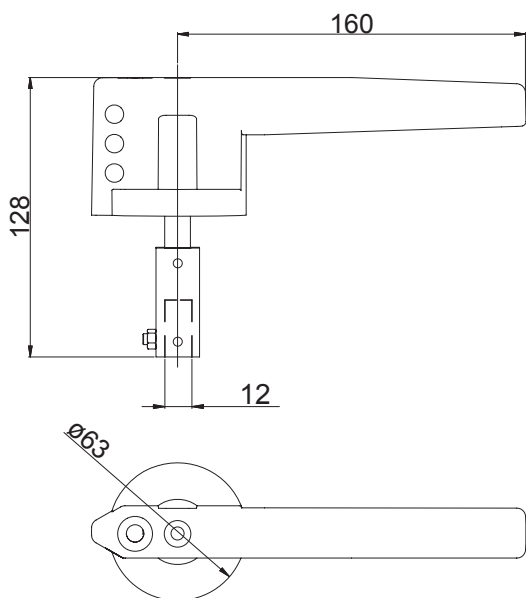

Maniglia nera \ Black handle 18187 | 18588 | 18589

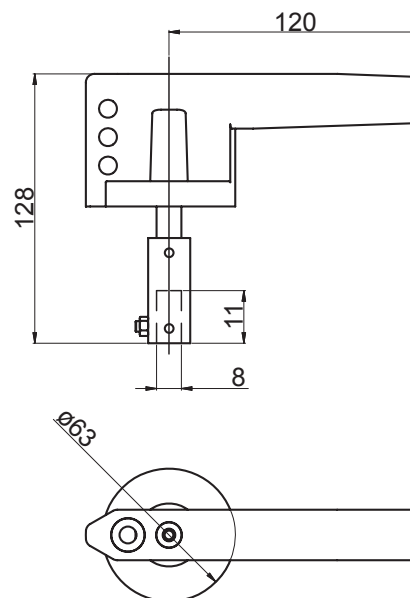

Maniglia nera \ Balck handle 18236  
 Maniglia rossa \ Red handle 18237

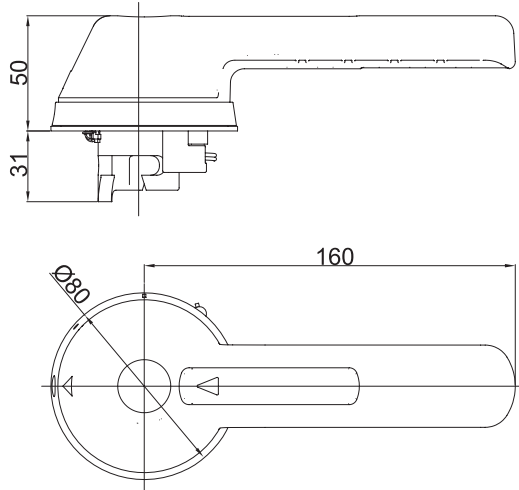

Maniglia nera \ Balck handle 18234  
 Maniglia rossa \ Red handle 18235

